

# MM G521.500



## CONTENT

<b>1 Introduction .....</b>	<b>2</b>	2.3 Cable Connection.....	9
1.1 Advantages.....	2	2.4 Mounting Drive Unit Casing.....	10
1.2 Scope of Application.....	2	2.5 Chain Wheel Parts Installation.....	12
1.3 Product Naming Protocol.....	2	2.6 Crank Installation.....	12
1.4 Drive Unit Appearance.....	3	2.7 External Speed Sensor Installation SR SD02.01.....	13
1.5 Drive Unit Structure and Dimensions.....	4	<b>3 List of Materials.....</b>	<b>16</b>
1.6 Main Technical Parameters.....	5	3.1 Drive Unit - MM G521.500.....	16
<b>2 Drive Unit Installation.....</b>	<b>6</b>	3.2 Cables.....	17
2.1 List of Tools to be used.....	6	Notes.....	18
2.2 Mounting Drive Unit.....	7		

# 1 INTRODUCTION

## 1.1 Advantages

With a maximum torque output of 120 Nm, the new M600 center drive system provides instant acceleration and ultimate uphill power for any off-road challenge. For hardtail or full suspension MTB designs. Motor weight < 3.7 kg.

## 1.2 Scope of Application

The drive unit works properly in the following environmental conditions:

- Ambient temperature: -20 to + 55°C ;
- Relative humidity: 15–95 % RH;

**i** The function of the product is impaired by the presence of any major caustic gas, any medium that affects the product's electrical insulation properties or any high-intensity magnetic field.

## 1.3 Product Naming Protocol

There is a badge on the housing, showing information as follows:

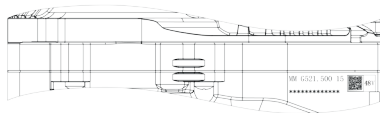

MM G521 500 15 033 F5 S329 0001  
A B C D E F G H

- A MM: Mid motor
- B G521: Motor model
- C 500: Rated motor power
- D 15: Number of winding turns
- E 033: Connection combination sort
- F F5: Measurement and control equipment number
- G S329: Date of manufacture, indicating it is manufactured on March 29, 2018
- H 0001: Production serial number, ranging from 0000 to 9999; 0001 is the production serial number of the first motor

## 1.4 Drive Unit Appearance



Motor with connection interface integrated with battery



Motor with normal connection interface

## 1.5 Drive Unit Structure and Dimensions

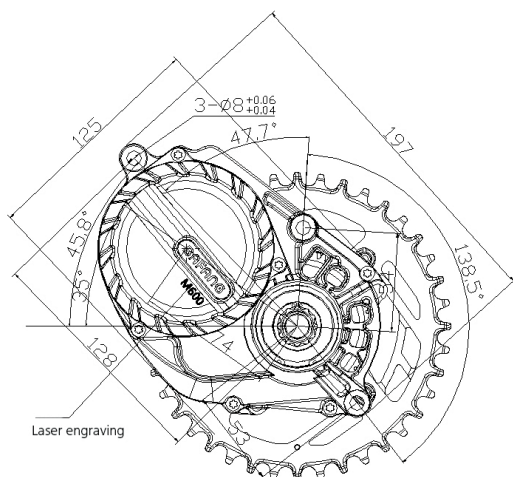
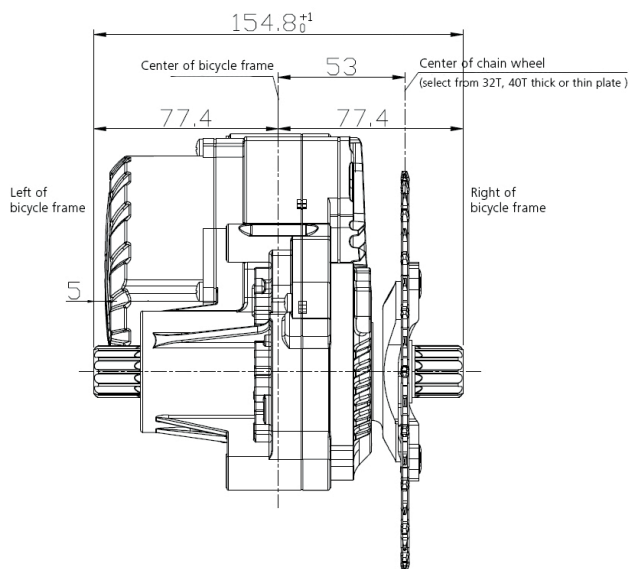







## 1.6 Main Technical Parameters

Rated voltage (V)	43	48
Rated power (W)	500	
Rated efficiency (%)	≥80%	
Rated rotating speed (rpm)	115±6	115±6
Maximum torque (Nm)	≥120	
Chain wheel	single 32T/ single 40T	
Optional chain guard	/	
Weight (Kg)	3.7(aluminium)	
Sensors	pedal assist sensor (torque speed) , bicycle wheel speed sensor and temperature sensor	
Noise (dB)	≤55	
Water-proof grade	IP66	
Certification	CE / EN14766 / RoHS	
Operating environment	-20 C ~55 C	
Functions	Light function: DC 6V/3W headlight & rearlight Optional functions: Bluetooth module, gear sensor, reprogramming function	

# 2 DRIVE UNIT INSTALLATION

## 2.1 List of Tools to be used

Use of the Tools	Tools
Bolts for connection of the motor to the connection interface	 Internal hexagonal wrench
Nuts for connection the motor to the connection interface	 External hexagonal sleeve
Tightening and loosening the lock ring of the chain wheel	Dedicated tools
Chain stand, chain stand screws	 T20 Torx screw driver
Covering case	 T10 Torx screw driver
Bash guard	 Internal hexagonal wrench
Crank mounting screw	 Internal hexagonal wrench
Connectors	Dedicated tools

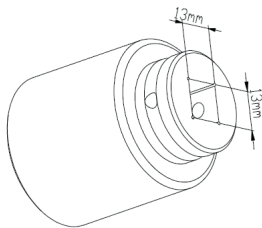

Dedicated tool for lock ring of the chain wheel

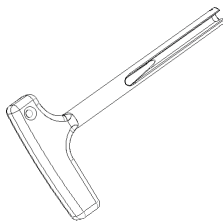



Dedicated tool for connectors

## 2.2 Mounting Drive Unit

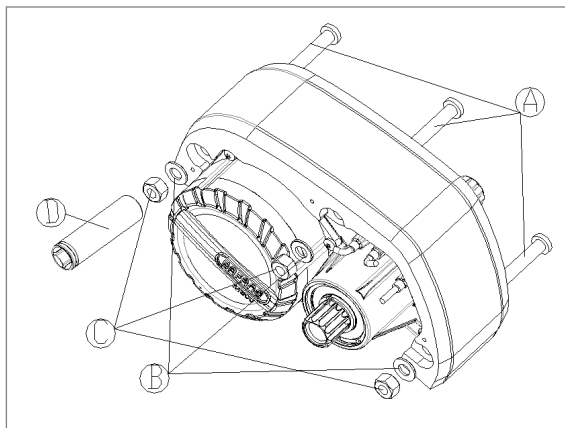
### 2.2.1 Install motor to normal connection interface

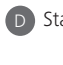

-  **A** M8 bolt  
140128000002
-  **B** M8 flat washer  
1401060000196
-  **C** M8 Lock ring  
1401080000127
-  **D** Standard tool

1) Align the 3 mounting holes of the motor with the mounting holes of the connection interface of the bicycle frame, insert the 3 dedicated M8 bolts into the three mounting holes from the right side of the bicycle frame, and pass through the motor and come out from the left side of the bicycle frame.

2) Tighten the 3 sets of M8 standard locking hex nuts (13\*13) and washers with the bolts on the left side of the bicycle frame, and lock them with the common tools as shown in the Figure with the tightening torque of 35N.m.

The size of the common tools made by the manufacturer:

Outside diameter is 17.7 mm and length is 63 mm.

Requirements for the tools:

Outside diameter is less than 20 mm and length is greater than 35 mm.

## 2.2.2 Install motor to connection interface integrated with battery

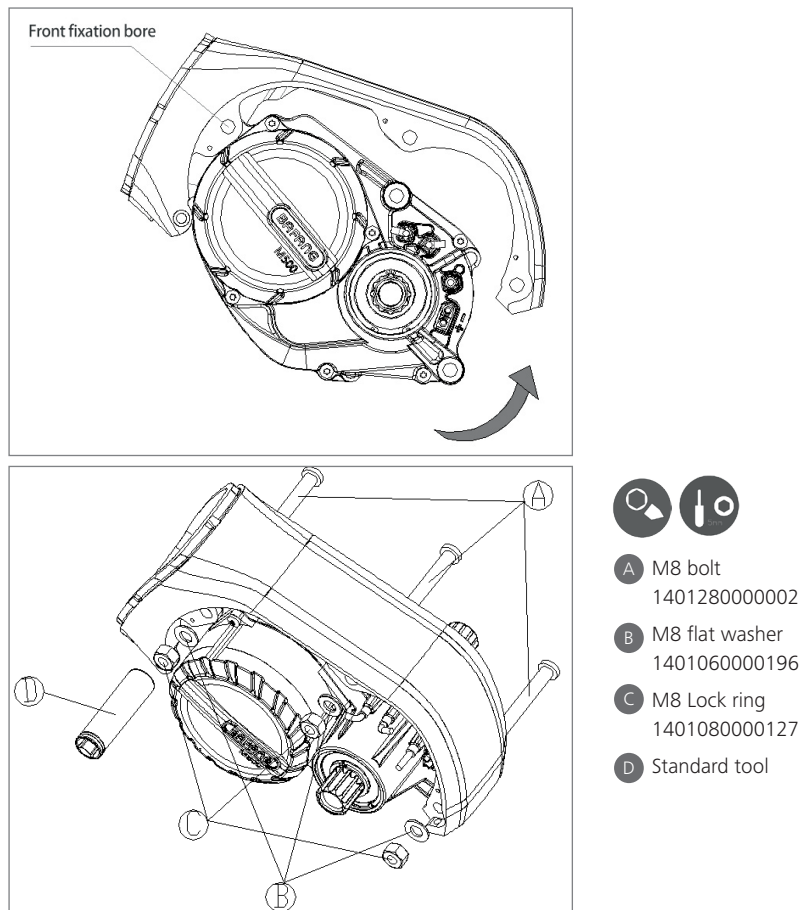

1) Firstly, align the front M8 screw hole of the motor shown in figure 1 to the front fixation bore of the interface, and then make this bore as the axis, turn the motor clockwise to align the other two mounting holes. insert the 3 dedicated M8 bolts into the three mounting holes from the right side of the bicycle frame, and pass through the motor and come out from the left side of the bicycle frame.

2) Tighten the 3 sets of M8 standard locking hex nuts (13\*13) and washers with the bolts with the bolts on the left side of the bicycle frame, and lock them with the common tools as shown in the Figure with the tightening torque of 35N.m.



The size of the common tools made by the manufacturer:

Outside diameter is 17.7 mm and length is 63 mm.

Requirements for the tools:

Outside diameter is less than 20 mm and length is greater than 35 mm.

## 2.3 Cable Connection

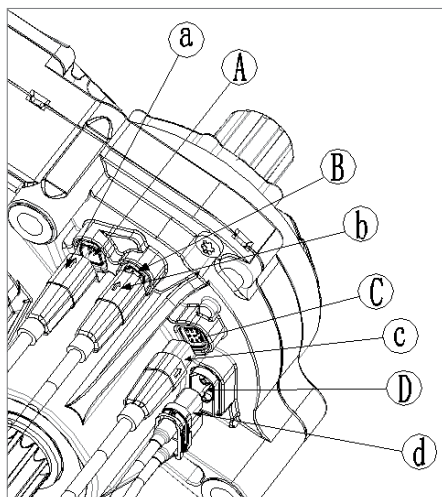

- Ⓐ Male eight-pin connector at the motor
- ⓐ Female eight-pin connector at the front BUS cable
- Ⓑ Male six-pin connector at the motor
- ⓑ Female six-pin connector for other device
- Ⓒ Female eight-pin connector at the motor
- ⓒ Male eight-pin connector rear BUS cable
- Ⓓ Male connector for power supply at the motor
- ⓓ Female connector for power supply at the battery

First, plug a into A and then plug c into C. At last, plug d into D. (The step to plug b into B depends on customer's requirement for function.)

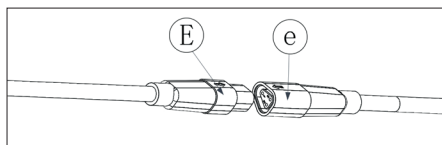

- Ⓔ Male three-pin connector at the battery
- ⓔ Female three-pin connector at BUS cable

Plug connector e from BUS cable to connector E from battery for communication.

## 2.4 Mounting Drive Unit Casing

### 2.4.1 Install down case and cover of normal version

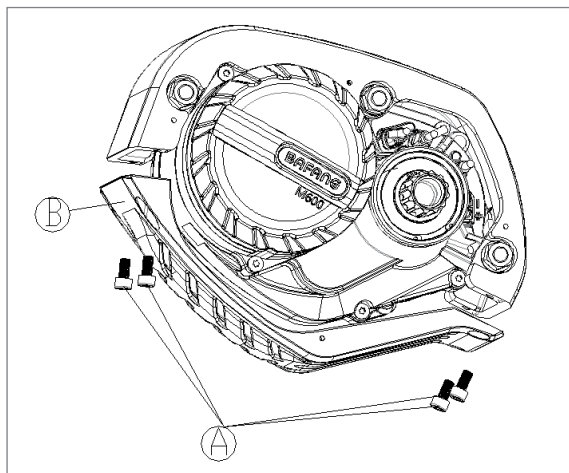

- A Hexagonal socket head cap screw M5\*8
- B Down case

Use internal hexagonal wrench to tighten 4 M5\*8 screws through hole sites on the down case to the connection interface, with tightening torque at 4 N.m.

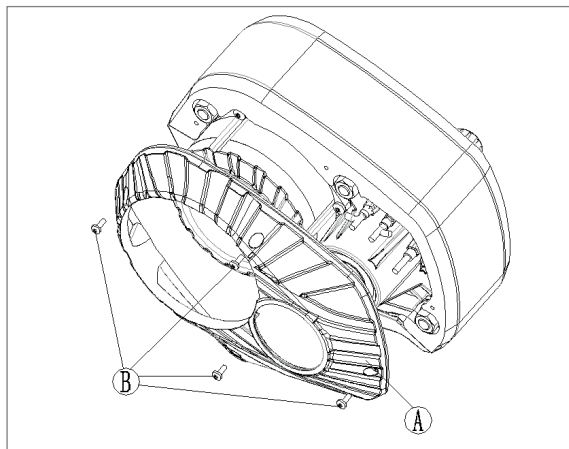

- A Covering case
- B Hexalobular socket pan head screw M3\*8

Use T10 Torx screw driver to tighten 4 M3\*8 screws through hole sites on the covering case to the connection interface and down case, with tightening torque at 1 N.m.

## 2.4.2 Install down case and cover of battery integrated version

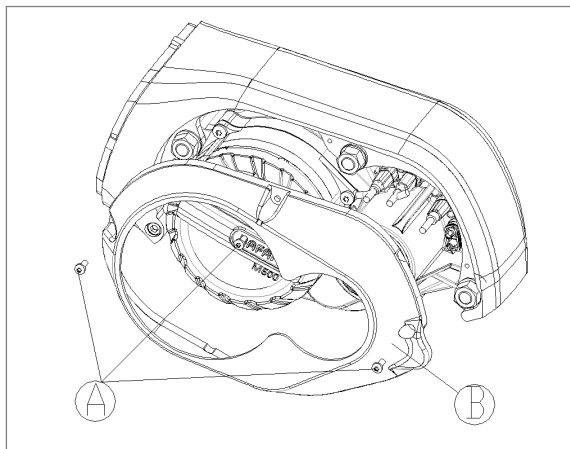

A Hexalobular socket pan head screw M3\*8



B Covering case

Use T10 Torx screw driver to tighten 3 M3\*8 screws through hole sites on the covering case to the connection interface and down case, with tightening torque at 1 N.m.

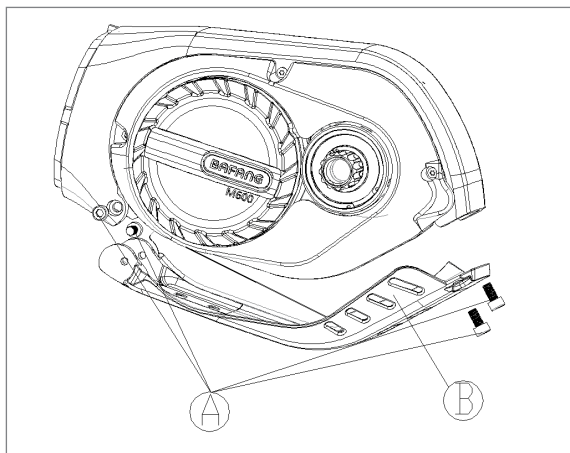

A Hexagonal socket head cap screw M5\*8



B Down case

As shown in the figure, use internal hexagonal wrench to tighten 2 M5\*8 screws through hole sites on the down case to the connection interface, with tightening torque at 4 N.m. Then, use internal hexagonal wrench to tighten 2 M5\*8 screws through hole sites on the connection interface to the down case, with tightening torque at 4 N.m.

## 2.5 Chain Wheel Parts Installation

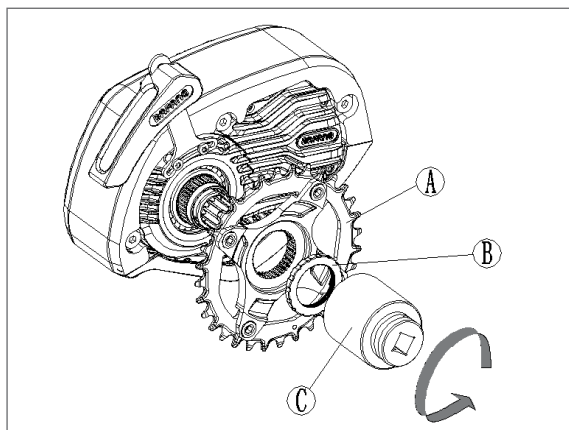

- A Chain wheel (Chain wheel shall be made according to orders of the customers)
- B Lock ring
- C Dedicated tool

Installation of the chain wheel: Align the splined teeth of the chain wheel with the splined teeth of the axle in motor, and insert the chain wheel, then use the tool to tighten the lock ring to the motor in a counterclockwise direction at the tightening torque of 35N.m.

## 2.6 Crank Installation

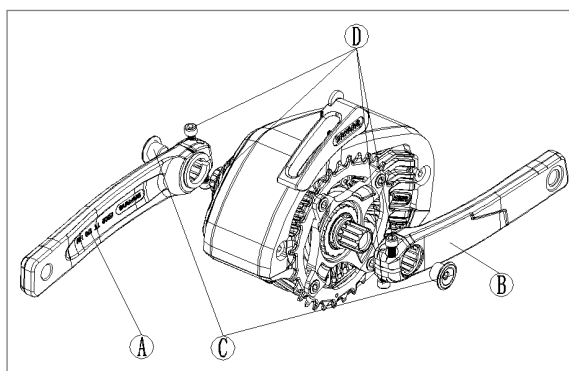

- A Left crank
- B Right crank
- C Screw (for the crank)
- D Hexagonal socket head cap screw M6\*20

Assemble the right crank to the center axle at the right side, lock screw C (for the crank) to the center axle with internal hexagonal wrench at the tightening torque of 1.5N.m; Tighten the 2 M6\*20 screw alternately with internal hexagonal wrench at the tightening torque of 15N.m (Attention: DO NOT tighten the screw one time at one side). Then assemble the left crank with the same method (guarantee the left crank and the right crank are in parallel direction).

## 2.7 External Speed Sensor Installation SR SD02.01

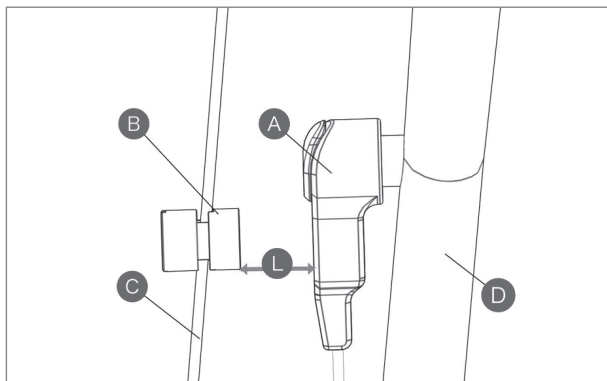

- (A) external speed sensor
- (B) magnet unit
- (C) spoke
- (D) chain stay

Before installing the speed sensor, please make sure the gap between the speed sensor and the magnetic unit is between 5 and 25 mm.

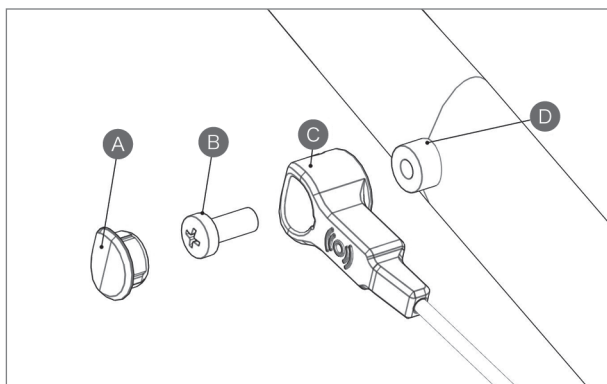

- (A) Dust cap  
2301030000003
- (B) mounting bolt M5×12
- (C) external speed sensor
- (D) sensor bracket (chain stay boss)

If the gap is within the specified range, use the mounting bolt to fix the speed sensor.

If the gap is more than 25 mm, please put spacers between the sensor and the chain stay boss to reduce this gap.

Tightening torque: 1.5–2 Nm

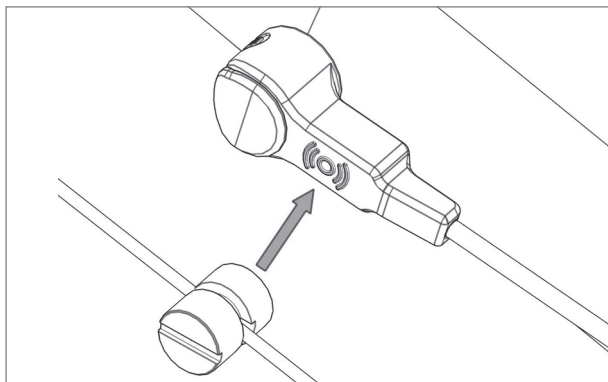

Arrange the speed sensor and the magnet unit as shown in the picture above. When installing the magnet unit, make sure its center is aligned with the center of the speed sensor's induction zone.

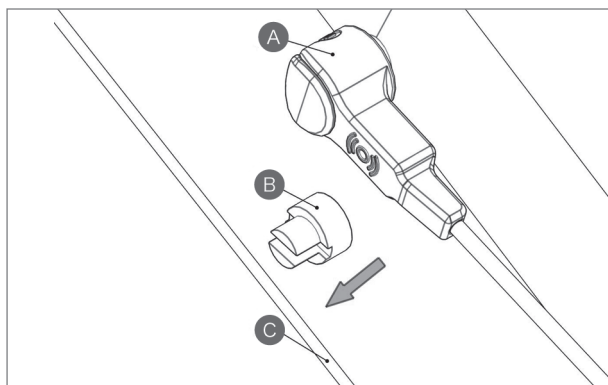

- (A) external speed sensor
- (B) magnet unit  
PS01010702/  
2308040000001
- (C) spoke

Arrange the speed sensor and the magnet unit as shown by the picture above. Mount the magnet unit onto the spoke.

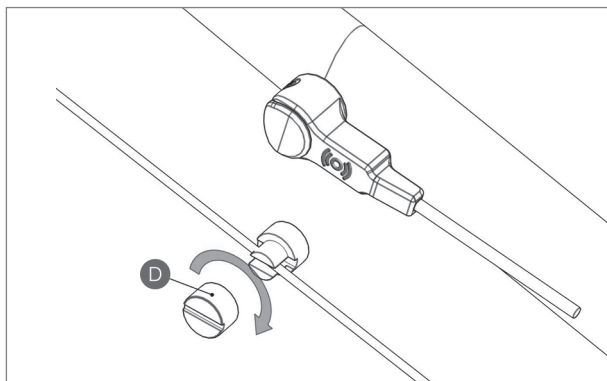

- D Mounting nut of the magnet  
PS01010701/  
2327000000003

Tighten up the mounting nut with a straight slot screwdriver. Tightening torque: 1.5–2 Nm

# 3 LIST OF MATERIALS

## 3.1 Drive Unit - MM G521.500

### 3.1.1 Drive Unit Accessories

Name	Material No.	Quantity	Specification
M8 flat washer	1401060000196	3	M8
M8 bolt	1401280000002	3	M8
M8 Lock ring	1401080000127	3	M8

### 3.1.2 Motor Cover Accessories

Name	Material No.	Quantity	Specification
Motor cover	1333000000021	1	
Motor cover (optional)	1333000000024	1	
Bash guard	1333000000023	1	
Bash guard (optional)	1333000000022	1	
Hexagonal socket head screw M3x8	1401020000268	4	M3x8
Hexagonal socket head screw M5x8	1401020000269	4	M5x8

### 3.1.3 Chain Wheel Module

Name	Material No.	Quantity	Specification
Chain wheel Module A	1325070000001		CL-52 mm/32 T
Chain wheel Module B (optional)	1325070000002		CL-52 mm/40 T
Lock ring	1334000000002		



### 3.1.4 Crank Components

Name	Material No.	Quantity	Specification
Right straight crank	1327070000002	1	170 mm
Left straight crank	1327070000001	1	170 mm
Crank mounting screws	1401020000266	2	

## 3.2 Cables

Name	Material No.	Quantity	Specification
Front BUS cable		1	according to order
Rear BUS cable		1	according to order
Battery cable		1	according to order
Headlight cable		1	according to order
Taillight cable		1	according to order

# NOTES

---



