



TABLE OF CONTENTS

INTRODUCTION	5	Detailed View	25
Intended Use.....	6	BATTERY AND MOTOR INSTALLATION	27
EPAC	6	CRANK AND SPIDER INSTALLATION	29
Safety Precautions.....	7	AVINOX SYSTEM	30
COMPONENT OVERVIEW	8	Drive System	30
TECHNICAL SPECIFICATION	9	Download Avinox App.....	30
GEOMETRY	10	Pair & Activate.....	30
ASSEMBLY & SETUP	12	Button Features	31
Handlebar.....	13	Assist Modes	32
Controls	14	Additional Modes.....	32
Universal Derailleur Hanger, UDH.....	15	BATTERY AND CHARGING	33
Speed Sensor Ring	15	Battery Disposal	33
Seatpost Insertion	16	Charging Instructions	34
Seatpost Adjustment.....	16	Charge Times.....	34
Tire Pressure Guide	17	Charging External Devices.....	34
Suspension Setup.....	18	BATTERY CARE, SAFETY & TRANSPORTATION GUIDELINES ..	35
T-Type Setup	19	MAINTENANCE	36
EXPLODED VIEWS	20	Replacing Parts.....	36
Seatstay and Chainstay	20	Taking Care of Carbon	37
Front Triangle	21	Crashes	37
Rocker Link and Main Pivot.....	22	After an Impact.....	37
Downtube Protection, Chainguide and Shock	23	Maintenance Schedule.....	38
CABLE ROUTING	24	WARRANTY	39
Overview	24	DECLARATION OF CONFORMITY	41

WE ARE MOUNTAIN BIKERS.

WE MAKE MOUNTAIN BIKES.

Congratulations, and thank you for choosing to purchase a bike from Forbidden. Like you, we love mountain biking and want you to have the best experience possible. We therefore recommend that you take the time to read through the guidelines and instructions set out in this manual before your first ride.

But before that, a few words about your new electric bicycle (e-bike). As the name suggests, and unlike regular bicycles, Forbidden e-bikes have carefully engineered electrical components, including an integrated motor and battery in the frame, sensors, a touchscreen display unit and wiring to connect the individual components. While riding your e-bike, you will experience added speed and acceleration from the motor's support. As a result, you will need to treat your e-bike differently from a regular bicycle and be careful not to damage the electrical components. This means you should not expose any electrical components to water, be careful while you wash your bike and do not pressure wash it. Handle your battery with care. Avoid dropping it, touching live components, opening it, or tampering with its electrical components. Be aware that a sufficiently charged lithium-ion battery contains enough energy to potentially cause a fire. Always follow the charging, transportation, cleaning, and storage instructions in this manual. Failure to do so may lead to serious consequences, including fire and potential injury to yourself and others.

Read this manual completely and contact us if you have any questions, contact@forbiddenbike.com

Product SKU & Serial Number:

Peel and stick label here

⚠ WARNING – Please read and familiarize yourself with the **IMPORTANT SAFETY INSTRUCTIONS PERTAINING TO THE RISK OF FIRE OR ELECTRIC SHOCK** in the **BATTERY AND CHARGER** section of this User Manual before riding or servicing your e-bike.

⚠ WARNING – Be careful not to damage or expose electrical components to water. Do not pressure wash your battery, motor, or any other electrical components. Damaging electrical components or exposing them to water may start a fire, resulting in serious injury or even death.

⚠ WARNING – Make sure to use the official AVINOX charger and plug the charger directly into a standard wall outlet; do not use extension leads.

⚠ WARNING – Always be present when charging your battery, and disconnect it when it is fully charged. Do not leave your battery plugged in or let it charge overnight. Immediately disconnect the battery from the charger when you encounter any problem during the charging process, e.g., when the charger or battery gets extremely hot or when the LED light signals a problem. Failure to follow this warning can start a fire, which can result in serious injury or even death. While charging, make sure to **NOT** move the bike or cranks and place the charger on a level surface. If in any doubt of catastrophic product failure whilst charging, such as visible gases or overheating, call your local Fire Department as soon as possible.

INTRODUCTION

**THIS MANUAL CONTAINS IMPORTANT SAFETY, PERFORMANCE AND SERVICE INFORMATION.
READ IT BEFORE YOU TAKE THE FIRST RIDE ON YOUR NEW E-BIKE, AND KEEP IT FOR REFERENCE.**

Additional safety, performance and service information for specific components such as suspension on your e-bike, or for accessories such as helmets or lights that you purchase, may also be available. Make sure that your authorized retailer has given you all the manufacturers' literature that was included with your e-bike or accessories. In case of a conflict between the instructions in this manual and information provided by a component manufacturer, always follow the component manufacturer's instructions. If you have any questions or do not understand something, take responsibility for your safety and consult with your authorized retailer or the e-bike's manufacturer.

This Manual contains many "Warnings" and "Cautions" concerning the consequences of failure to maintain or inspect your e-bike and of failure to follow safe cycling practices.

NOTE: This manual is not intended as a comprehensive use, service, repair or maintenance manual. Please see your authorized retailer for all service, repairs or maintenance. Like any sport, bicycling involves the risk of injury and damage. By choosing to ride an e-bike, you assume the responsibility for that risk, so you need to know – and to practice – the rules of safe and responsible riding and of proper use and maintenance. Proper use and maintenance of your e-bike reduces the risk of injury.

 + **WARNING** The combination of the safety alert symbol and the word **WARNING** indicates a potentially hazardous situation which, if not avoided, could result in serious injury or death.

 + **WARNING** The combination of the fire hazard alert symbol and the word **WARNING** indicates a potentially hazardous situation which, if not avoided, could cause a sudden and severe fire, which could result in serious injury or death.

 + **CAUTION** The combination of the safety alert symbol and the word **CAUTION** indicates a potentially hazardous situation which, if not avoided, could result in minor or moderate injury, or is an alert against unsafe practices.

 + **CAUTION** The combination of the hot surface alert symbol and the word **CAUTION** indicates a potentially hazardous situation which, if not avoided, could result in burns.

CAUTION The word **CAUTION** used without the safety alert symbol indicates a situation which, if not avoided, could result in serious damage to the e-bike or the voiding of your warranty.

SYMBOL KEY

 Safety Alert Symbol  Fire Hazard Alert Symbol  Hot Surface Alert Symbol

Many of the Warnings and Cautions say, "You may lose control and fall". Because any fall can result in serious injury or even death, we do not always repeat the warning of possible injury or death. Because it is impossible to anticipate every situation or condition that can occur while riding, this Manual makes no representation about the safe use of the e-bike under all conditions. There are risks associated with the use of any e-bike which cannot be predicted or avoided and which are the sole responsibility of the rider.

INTRODUCTION

INTENDED USE



All Mountain trail and uphill riding. Forbidden e-bikes are designed and **INTENDED** for riding conditions 1, 2 and 3, plus rough technical areas, moderate-sized obstacles, and small jumps. Below is a description of each condition.

NOT INTENDED for use in extreme forms of jumping/riding such as hardcore mountain, free riding, downhill, North Shore, dirt jumping, trick jumping, hucking, etc. Not for large dropoffs, jumps or launches (wooden structures, dirt embankments) requiring long suspension travel or aftermarket heavy-duty components.

CONDITION	DESCRIPTION	JUMPING LIMITATION
CONDITION 1	Flat and smooth paved surfaces, with tires on the ground while riding.	Not Supported
CONDITION 2	Including condition 1, plus unpaved gravel roads and trails with moderate grades, the tires can occasionally lift off the ground while riding.	<15 cm
CONDITION 3	Including conditions 1 and 2, as well as rough roads and paths that require technical skills.	<60 cm
CONDITION 4	Including conditions 1, 2, and 3, plus rough technical areas that require advanced technical skills, and moderately sized obstacles. Small jumps are supported during riding.	<120 cm
CONDITION 5	Including conditions 1 to 4, as well as professional tracks and rugged terrains that requires extreme jumping maneuvers.	Unlimited

WARNING

This is a mountain bike, not a cargo bike. We do not recommend the use of bicycle trailers, carriers or child seats.

EPAC

This bike is classified as an EPAC (Electrically Power Assisted Cycles). Regardless of its specific classification, the electric motor in this bicycle will only provide assistance when the rider is pedalling. Different classifications of electric bicycles may have varying regulations and requirements that could affect how and where you can use the bike. The motor's assistance will automatically stop if you stop pedalling or if you reach the maximum allowed speed for assistance.

This bike is not intended for use by persons under the age of 16, unless supervised by an adult and as permitted by local laws. Always check local regulations before use.

INTRODUCTION

SAFETY PRECAUTIONS

- Always wear a helmet, protective gear and appropriate clothing.
- Electric bikes accelerate much faster than regular bikes.
Make sure to pay particular attention to terrain conditions during riding.
- During riding, pay attention to the road hazards such as potholes, road shoulders, drains, or objects that may damage the wheels.
- Do not apply excessive brake force to the front wheel suddenly, as this could lift the rear wheel off the ground and result in a fall.
- Be careful to keep your body away from the sharp teeth of chainrings, the moving chain, and the spinning wheels.
- Ensure the e-bike is turned OFF while:
 - Loading the bicycle for transportation.
 - Carrying the bicycle.
 - Fixing a dropped chain.
 - Installing or removing a pedal.
 - Changing a flat tire.
- Performing chain/drivetrain maintenance.
-  The brake rotors and the motors may become hot during use.
Do not touch.
- If you are going to be riding on public roads, please check with local government guidelines and laws to ensure your bike is compliant and what steps need to be taken, ie, fitting a bell and reflectors.
Do not ride with headphones.
- If you are going to be venturing out at night, be sure to follow local laws, which will likely require the use of front and rear lights, but check with your local government to make sure you are compliant.
- When riding in the wet, braking distances are increased and traction is decreased. While riding off-road in the wet is fun, please be careful out there and give yourself more time to slow down and be cautious of slippery surfaces.
- Follow your local e-bike regulations for trail usage.
- Inform yourself of all applicable legal requirements and regulations in your country or state. There may be restrictions on riding your e-bike on public roads, cycling paths, and/or trails. There may also be applicable helmet requirements, age restrictions, license, or insurance requirements. Forbidden Bike Company offers no guarantees, representations, or warranties concerning the use of your e-bike. As laws and regulations regarding e-bikes vary by country and/or state and are constantly changing, make sure to get the latest information.
- Modifying or manipulating your e-bike's speed limit may change its classification, which, depending on the country or state, may make the electric bicycle no longer approved for use on public roads.
- Do not exceed the recommended combined weight (rider and bike) limit of 136kg (300lbs).

COMPONENT OVERVIEW



COMPONENTS

1	Brake Lever	17	Rear Derailleur
2	Wireless Controller	18	Cassette
3	Seatpost Lever	19	Brake Rotor
4	Handlebar	20	Chainstay
5	Stem	21	Chain
6	Control Display	22	Chain Guide
7	Shift Lever	23	Chainring
8	Top Tube	24	Crank
9	Rear Shock	25	Drive Unit
10	Saddle	26	Internal Battery
11	Seatpost	27	Downtube
12	Seatpost Clamp	28	Head Tube
13	Seat Tube	29	Fork
14	Rock Link	30	Spoke
15	Seatstay	31	Rim
16	Brake Caliper	32	Tire

Frame	Lightweight Carbon Fibre
Motor	Avinox Motor, with 250 watts continuous power and 105Nm torque
Battery	36V lithium-ion in 600Wh or 800Wh, depending on model
Display	LCD touchscreen with navigation
Controller	Bluetooth Wireless Handlebar Controller
Suspension	Front & Rear hydraulic shocks
Brakes	Front & Rear hydraulic disc brakes
Wheels	29" Front, 27.5" Rear "MX" set up with all-terrain tubeless tires

TECHNICAL SPECIFICATIONS

SPECS *PER FRAME SIZE

FORK LENGTH (MAX.)	586 mm
RECOMMENDED FORK OFFSET	44 mm
SHOCK LENGTH (EYE-EYE)	210 mm
SHOCK STROKE	55 mm
SHOCK HARDWARE (BOTH ENDS)	30x8 mm
HEAD TUBE DIAMETER LOWER	44 mm
S.H.I.S	55.95 mm
REAR DROPOUT SPACING (O.L.D)	ZS44/28.6 ZS56/40
REAR AXLE SPECIFICATION	148 mm
BOTTOM BRACKET	L 180 mm/TL 20 mm/TP M 12x1.00
CHAIN LINE (CL)	N/A
MAX CHAIN RING*	55 mm
CHAIN LENGTHS*	S1: 120 S2: 122 S3: 124 S4: 126
SEAT POST DIAMETER	31.6 mm
MAX. SEAT POST INSERTION*	S1: 260 S2: 275 S3: 290 S4: 310
SEAT CLAMP DIAMETER	34.9 mm (Included)
BRAKE MOUNT	200 mm Post Mount
ISCG 05	N/A
RECOMMENDED TIRE SIZE	27.5 x 2.5
MAX. TIRE SIZE	27.5 x 2.6
MAIN PIVOT BEARINGS	6903 Max (17mm x 30mm x 7mm) QTY: 2 6903 Max (17mm x 30mm x 7mm) QTY: 2
ROCKER LINK BEARINGS	6901 Max (12mm x 24mm x 6mm) QTY: 2
HORST LINK PIVOT BEARINGS	6901 Max (12mm x 24mm x 6mm) QTY: 4
TRUNNION MOUNT BEARINGS	6901 Max (12mm x 24mm x 6mm) QTY: 4
IDLER PULLEY BEARING	6903 Max BOSL (17mm x 30mm x 30mm) QTY: 2

AVINOX DRIVE SYSTEM SPECS

BATTERY	600Wh	800Wh
BATTERY TYPE	LI-ION	LI-ION
VOLTAGE	35.9 V	35.9V
PROTECTION RATING	IP56	IP56
CAPACITY	22.3 Ah	16.7 Ah
ENERGY	800 Wh	600 Wh
WEIGHT	APPROX. 3.74kg	APPROX. 2.87kg
CHARGING TIME		
168W CHARGER	APPROX. 5h 50m (0-100%)	APPROX. 4h 45m (0-100%)
	APPROX. 4h 28m (0-75%)	APPROX. 3h 3m (0-75%)
508W CHARGER	APPROX. 2h 25m (0-100%)	APPROX. 2h 25m (0-100%)
	APPROX. 1h 30m (0-75%)	APPROX. 1h 30m (0-75%)

DRIVE UNIT	
CONTINUOUS RATED POWER	250 W
PEAK POWER	850 W (NORMAL) : 1000 W (BOOST)
MAXIMUM DRIVE TORQUE	105Nm (NORMAL) : 120 Nm (BOOST)
TORQUE DENSITY	45 Nm/Kg
MAXIMUM CADENCE	150 RPM
PROTECTION RATING	IP66
WEIGHT	APPROX. 2.52 Kg

TOUCH SCREEN AND CONTROLS

CONTROL DISPLAY

SCREEN	2.0-Inch OLED, 326 PPI, 800 NIT
EXPANSION PORT	12 V 2.0 A, 24 W
4G LTE	LTE-CAT.1
BLUETOOTH	BLE 5.1
POWER OUTPUT PORT	USB-C PD 3.0 65 W

SENSING SYSTEM

Built-in IMU, Barometer, Comapsss, Ambient Light Sensor, Torque/Cadance/ Wheel Speed Sensors
8 GB

STORAGE CAPACITY

WIRELESS CONTROLLERS

BLUETOOTH	BLE 5.1
BATTERY	CR1620

GEOMETRY

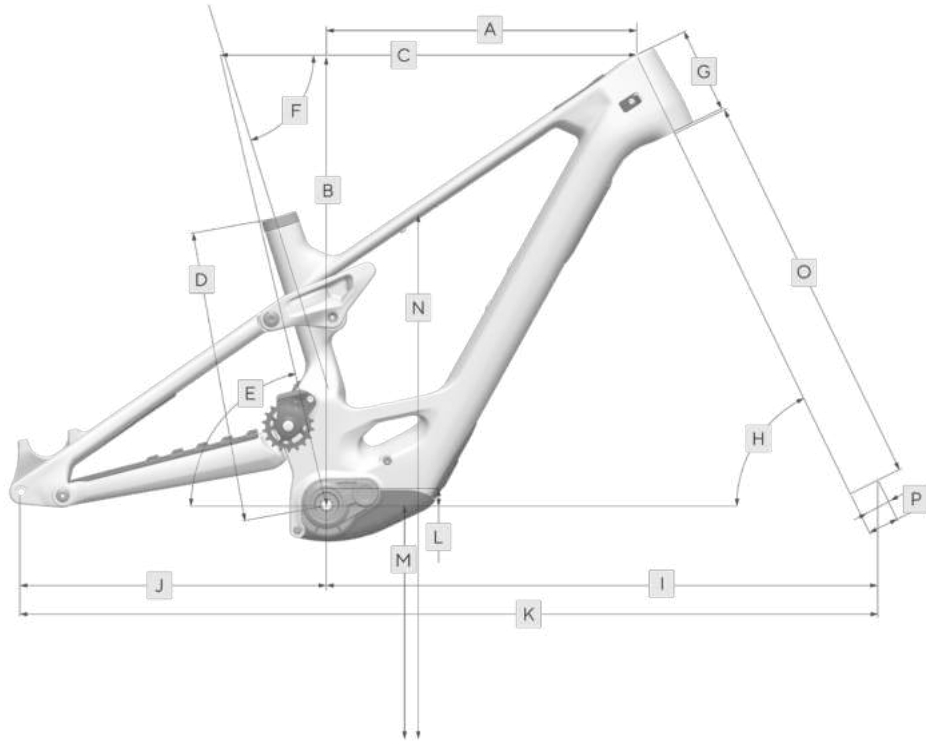

LYRIK 150mm - MX		S1	S2	S3	S4
A	Reach	437	454	474	493
B	Stack	623	644	657	671
C	Horizontal Top Tube Length	576	598	621	644
D	Seat Tube Length	400	420	440	470
E	Seat Tube Angle (effective)	77.4	77.4	77.4	77.4
F	Seat Tube Angle (actual)	71.5	73.3	75.2	76.8
G	Head Tube Length	100	123	138	153
H	Head Tube Angle	64.6	64.6	64.6	64.6
I	Front Center	762	788	814	841
J	Rear Center	427	441	456	470
K	Wheelbase	1189	1229	1270	1311
L	BB Drop	-29.9	-29.9	-29.9	-29.9
M	BB Height*	331	331	331	331
N	Standover Height*	740	740	740	740
O	Fork Length	561	561	561	561
P	Fork Offset	44	44	44	44

*Based on 29x2.4 Tire (OD 746mm) Front and 27.5x2.5 Tire (OD 708) Rear

GEOMETRY

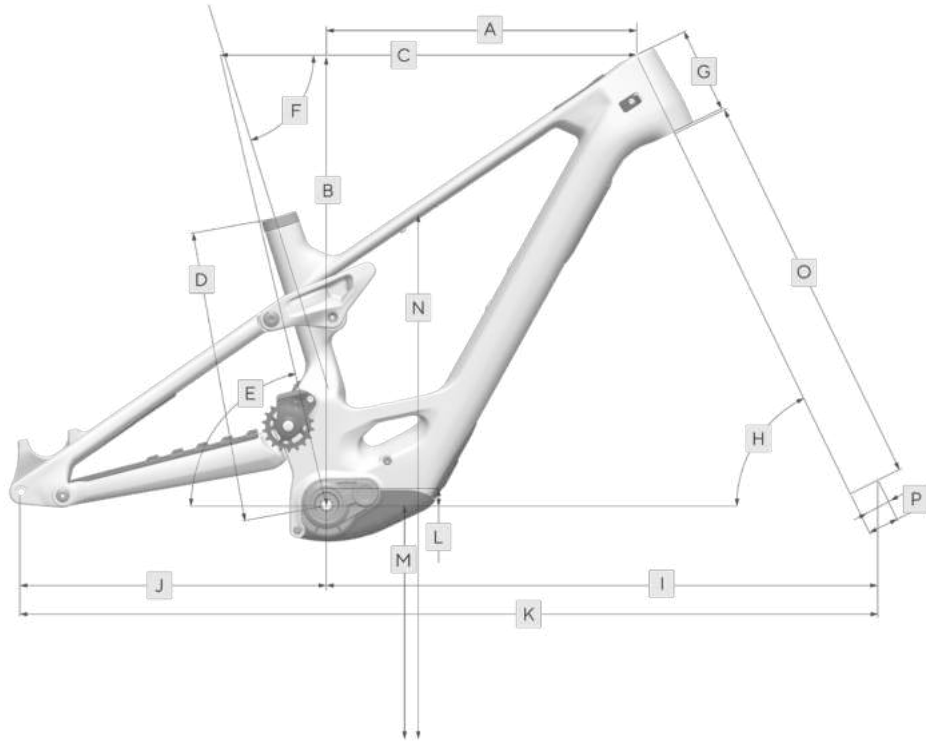

ZEB 160mm - MX		S1	S2	S3	S4
A	Reach	430	447	467	487
B	Stack	628	649	662	676
C	Horizontal Top Tube Length	578	599	622	646
D	Seat Tube Length	400	420	440	470
E	Seat Tube Angle (effective)	76.5	76.5	76.5	76.5
F	Seat Tube Angle (actual)	70.8	72.7	74.5	76
G	Head Tube Length	100	123	138	153
H	Head Tube Angle	64	64	64	64
I	Front Center	767	794	820	847
J	Rear Center	427	442	456	471
K	Wheelbase	1194	1235	1276	1317
L	BB Drop	-25	-25	-25	-25
M	BB Height*	335.8	335.8	335.8	335.8
N	Standover Height*	745	745	745	745
O	Fork Length	576	576	576	576
P	Fork Offset	44	44	44	44

*Based on 29x2.4 Tire (OD 746mm) Front and 27.5x2.5 Tire (OD 708) Rear

ASSEMBLY & SETUP

THIS MANUAL IS NOT A SUBSTITUTE FOR PROFESSIONAL ASSEMBLY, USE, SERVICE, REPAIR, OR MAINTENANCE. ALWAYS CONSULT YOUR AUTHORIZED FORBIDDEN DEALER FOR THESE SERVICES.

WARNING

Professional Assembly Required.

Due to the bicycle's complexity, proper assembly necessitates significant mechanical expertise, skill, training, and specialized tools. For your safety, entrust assembly, maintenance, and troubleshooting to your authorized Forbidden dealer.

WARNING – Pre-Ride Check.

Before your initial ride, ensure all components, including brakes and the drivetrain, are correctly assembled, adjusted according to the manufacturer's instructions, and functioning as intended.

WARNING – Proprietary Components.

Many bicycle parts, such as the motor, battery, and cable guides, are specific to this model. Always use only the original components and hardware provided. Using other parts will compromise the bicycle's structural integrity. Druid-E specific components are exclusive to Druid-E models and should not be used on other bicycles, even if they fit. Failure to adhere to this warning could lead to severe injury or death.

WARNING – No Modifications.

Never alter your frame or bicycle in any way. Do not sand, drill, file, or remove any parts. Avoid installing incompatible components or hardware. Ignoring this warning may result in serious personal injury or death.

WARNING – Electrical Safety.

Exercise caution when working on your bicycle, as electrical components may be exposed. Never touch any part of the electrical system while it is charged. Keep battery and frame connections away from water. If any live components or the battery are damaged, stop riding immediately and take your bicycle to your authorized Forbidden dealer.

WARNING – Properly tighten hardware.

Always tighten hardware to the specified torque. Over-tightening hardware could deform or break the hardware or components. Under-tightening hardware could cause hardware or components to become loose. Either situation could damage the bicycle and result in injury to the rider.

WARNING – Reapply threadlocker.

All reused fasteners with pre-applied threadlocker must be cleaned with isopropyl alcohol and have new threadlocker applied before re-assembly. If threadlocker is not applied, the fasteners may loosen, which could damage the bicycle and result in injury to the rider.

ASSEMBLY & SETUP

HANDLEBAR

Install the handlebar in your desired position. Place the faceplate/s [A] over the handlebar, then install the faceplate screws [B] and loosely tighten.



ASSEMBLY & SETUP

HANDLEBAR

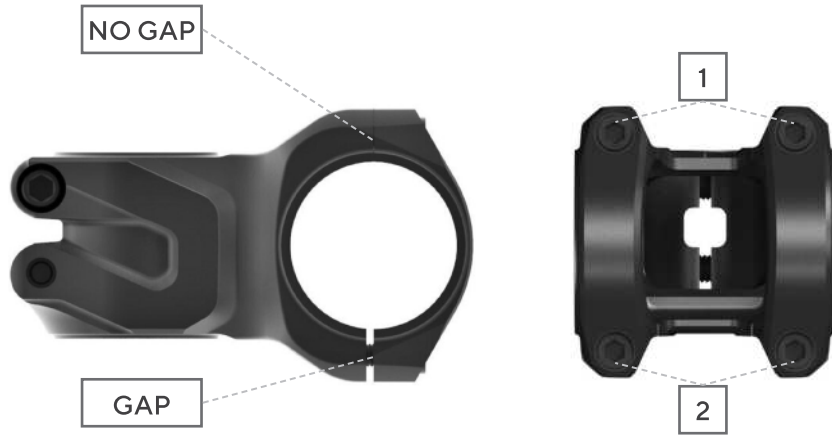

NO GAP STEMS

Orientation of the faceplate. Tighten the upper faceplate screws [1] in an alternating pattern to the required torque stated on the stem. Next, tighten the lower faceplate screws [2] in an alternating pattern to the required torque stated on the stem.

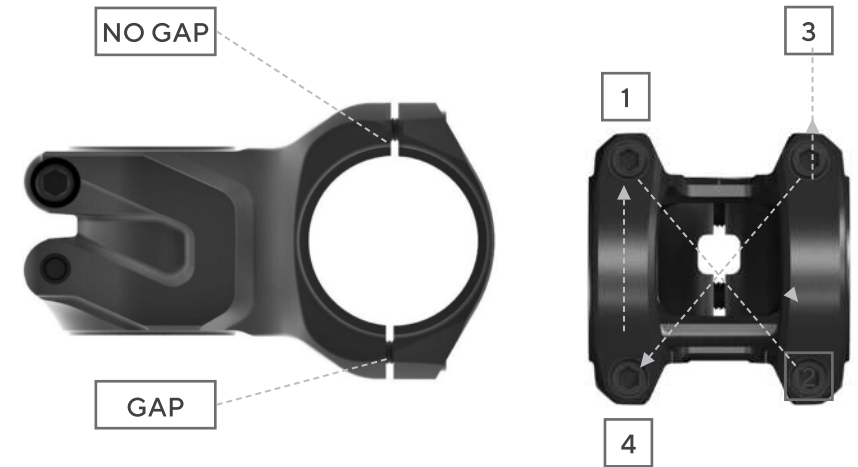

EQUAL GAP STEMS

Ensuring to maintain an equal gap top and bottom, tighten each faceplate screw [1 -> 2 -> 3 -> 4] approximately half a turn at a time in an alternate cross pattern until each screw is at the required torque stated on the stem.

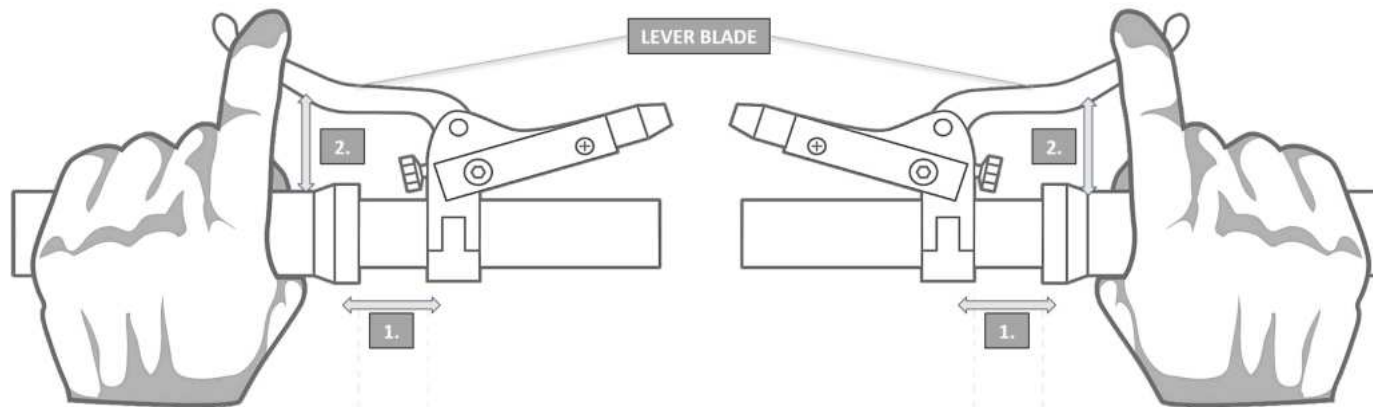

CONTROLS

With the handlebar in place, let's dial in your cockpit.

1. Position the brake levers to your desired distance from your grips. We recommend 20mm from the end of the grip as a good starting point.
2. Then use the reach adjusters to set the distance of the level blade from the grip.

ASSEMBLY & SETUP

UNIVERSAL DERAILLEUR HANGER, UDH

The universal derailleur hanger, UDH, is mounted on the rear dropout of the bike. Follow the steps below to replace it.



A - UDH 8mm Hex [25Nm]

B - Rear Axle 5mm Hex [12Nm]

1. Remove the rear wheel. Using an 8mm hex, loosen the UDH hanger bolt [A] clockwise, and then remove the bolt and the UDH hanger.
2. Install a new UDH hanger into the frame dropout and rotate it until it completely contacts the stop tab.
3. Install the UDH washer and bolt, then tighten it counter-clockwise to the required torque.
4. Mount the rear wheel and install the rear axle [B], tightening the axle to the required torque.

SPEED SENSOR RING

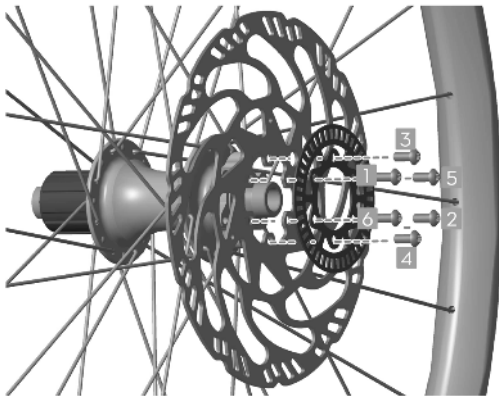

The speed sensor ring is mounted on the rear brake rotor.

When replacing the rear wheel or rear brake rotor, ensure to detach the speed sensor ring and mount it onto the new rear wheel. Tighten the bolts in the following order, see the illustration for reference.

1 -> 2 -> 3 -> 4 -> 5 -> 6 - Rotor Bolts T25 [5Nm]

ASSEMBLY & SETUP

SEATPOST INSERTION

Both our frame and seatpost have insertion requirements. Failure to follow these requirements may result in damage to the frame and seatpost

FRAME SIZE MAX INSERTION (mm)

S1	260
S2	275
S3	290
S4	310

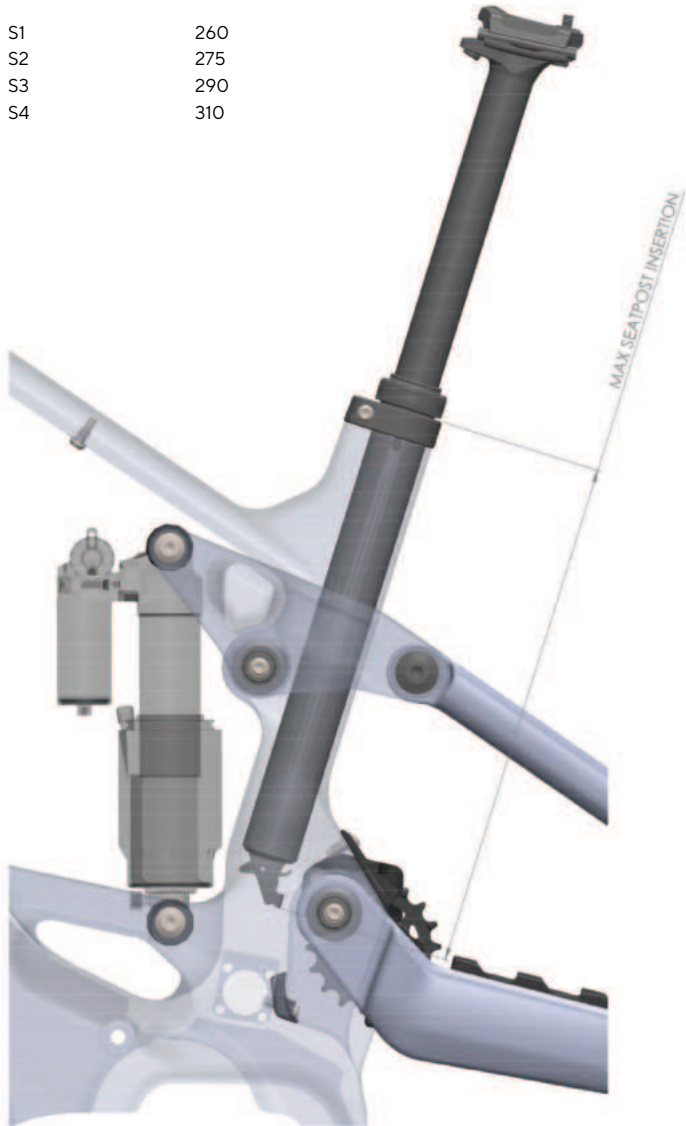

SEATPOST ADJUSTMENT

A - Seat Clamp Screw 5mm Hex [6Nm]

B - Cable Port Screw 4mm Hex [2Nm]

1. Loosen the seat clamp screw [A] using a 5mm hex
2. Loosen the cable port screw [B] using a 4mm hex so that the cable housing for the dropper is free to move in the cable port
3. If you need to lift the seatpost up, then feed the cable housing into the frame. If the seatpost is being lowered, pull the excess cable out from the frame.
4. Once your adjustment is complete, tighten the seat clamp screw to the required torque. Then pull tight on the cable housing at the headtube to remove any slack from inside the frame. This will stop the cable from rattling while riding

Please refer to the cable routing section if you are required to change the dropper cable housing.

If the correct seat height cannot be achieved within the minimum or maximum insertion requirements, the seatpost should be replaced with a different length.

ASSEMBLY & SETUP

TIRE PRESSURE GUIDE

 **WARNING** DO NOT EXCEED THE MAXIMUM PRESSURE LIMIT OF THE MANUFACTURER.
SEE THE TIRE SIDEWALL FOR INFORMATION.

Before riding, inflate the tires to the recommended pressure according to your weight, including riding gear.
Ensure you have a Presta valve pump and an accurate pressure gauge.

RIDER WEIGHT (lbs)	RIDER WEIGHT (kg)	AIR PRESSURE FRONT/REAR (PSI)	AIR PRESSURE FRONT/REAR (KPa)
120-130	54-59	19/22	131/152
130-140	59-63	19/22	131/152
140-150	63-68	20/23	138/159
150-160	68-73	21/24	145/165
160-170	73-77	21/24	145/165
170-180	77-82	22/25	152/172
180-190	82-86	22/25	152/172
190-200	86-91	23/26	159/179
200-210	91-95	23/26	159/179
210-220	95-100	24/27	165/186
220-230	100-104	24/27	165/186
230-240	104-109	25/28	172/193
240-250	109-113	25/28	172/193

ASSEMBLY & SETUP

SUSPENSION SETUP

⚠️ WARNING DO NOT EXCEED THE MAXIMUM PRESSURE LIMIT OF THE MANUFACTURER. REFER TO THE MANUFACTURER'S MANUAL FOR MORE INFORMATION.

Your weight, riding style and the trails you ride the most all factor into how you will want to set up your suspension. Personal preferences will determine the exact settings that will work best for you.

As a starting point, use the manufacturer's set-up guide for the front suspension fork base settings.

For the rear shock, we spend a lot of time working on suspension tunes and pressures for different rider weights. Please refer to our suspension set-up guide for optimal performance. Use the links below to access them:



VIVID Air
Shock Set Up



Super Deluxe
Shock Set Up

⚠️ WARNING YOUR BIKE'S HANDLING IS HIGHLY INFLUENCED BY EACH AND EVERY ADJUSTMENT MADE TO EITHER YOUR FORK OR SHOCK'S ADJUSTMENT DIALS. PLEASE TAKE IT EASY ON YOUR FIRST TEST RIDE, AND TO REDUCE THE LIKELIHOOD OF CRASHING, MAKE SMALL AND INCREMENTAL CHANGES TO YOUR FORK AND SHOCK SETTINGS, MAKING MENTAL OR PHYSICAL NOTES AS TO WHERE YOU ARE WITH YOUR SETTINGS.

ASSEMBLY & SETUP

T-TYPE SETUP

PREPERATION

Before the transmission can be installed, the chain length and derailleur must be prepared.

CHAIN LENGTH

See the table to find the recommended chain length for your frame size.

CHAIN LENGTH GUIDE

FRAME SIZE	SETUP KEY	SETUP COG	CHAIN LENGTH	CR. SIZE	MAX CR. SIZE
S1	A	6	120 LINKS	34T	36T
S2	A	6	122 LINKS	34T	36T
S3	A	6	124 LINKS	34T	38T
S4	A	6	126 LINKS	34T	38T

SRAM's T-Type transmission requires a specified setup procedure based on chain length and derailleur configuration. This setup does away with the need for b-tension adjustments.

For the full Eagle Transmission setup guides, please scan or follow the links below:

NOTE: SRAM T-Type is only compatible with frames equipped with SRAM's Universal Derailleur Hanger (UDH) fitment.



Mechanical T-Type
Set Up



AXS T-Type
Set Up

EXPLODED VIEWS

SEATSTAY & CHAINSTAY

ITEM NO.	PART NO.	DESCRIPTION	QTY
1	-	CHAINSTAY	1
2	004.002.0026	V3 CHAINSTAY PROTECTOR	1
3	004.002.0027	V3 SEATSTAY PROTECTOR	1
4	-	SEATSTAY	1
5	002.001.0011	SHAFT 12x30	2
6	004.001.0014	CABLE PORT SINGLE ALTERNATIVE SIDE	1
7	003.007.0002	ACCESSORY SCREW	2
8	-	ENDURO 6903 LLU MAX	2
9	002.004.0022	SPACER 17x49.5	1
10	002.004.0014	SHIELD SPACER 17x2.25	2
11	-	ENDURO 6901 LLU MAX	4
12	002.004.0016	SPACER 12x1.5	2
13	002.004.0020	SPACER 12x3	4
14	004.001.0012	CABLE PORT TRIPLE	1

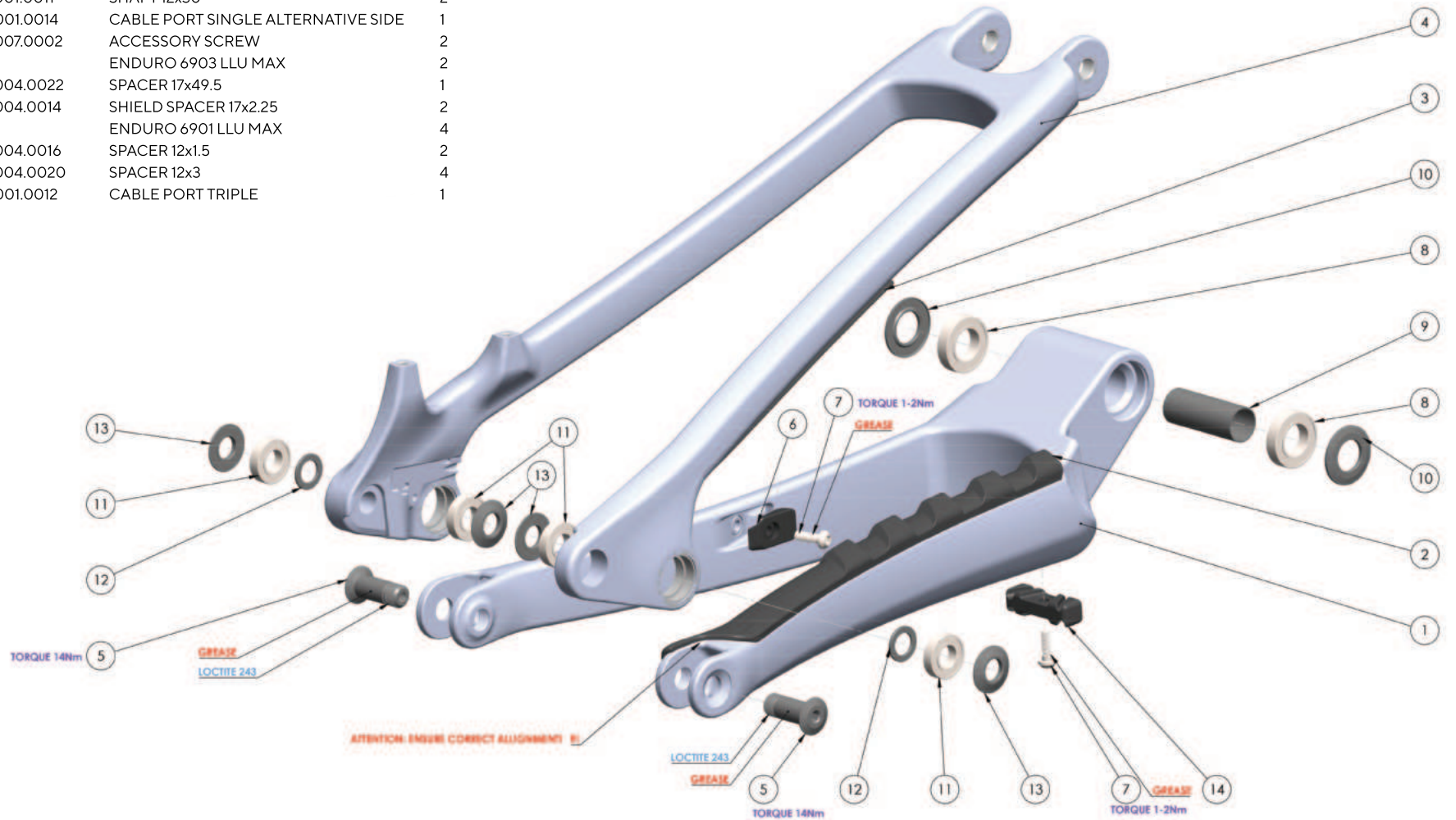

EXPLODED VIEWS

FRONT TRIANGLE

ITEM NO.	PART NO.	DESCRIPTION	QTY
15	003.006.0001	SEAT CLAMP	1
16	003.006.0001	SEAT CLAMP BARREL	1
17	003.007.0005	SEAT CLAMP SCREW	1

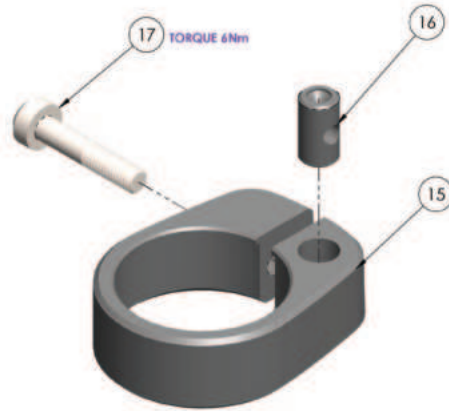

ITEM NO.	PART NO.	DESCRIPTION	QTY
7	003.007.0002	ACCESSORY SCREW	7
18	-	FRONT TRIANGLE	1
19	-	FENDER	1
20	004.001.0003	CABLE PORT SINGLE	2
21	-	SEAT CLAMP ASSEMBLY	1
22	002.004.0018	SPACER 17x31.5	1
23	-	ENDURO 6903 LLU MAX	2
24	-	ENDURO 6903 LLU MAX SOLID LUBE	2
25	002.004.0014	SHIELD SPACER 17x2.25	2
26	003.001.0024	IDLER PULLEY SCREW [DOUBLE BEARING] - 10x1	1
27	003.001.0023	IDLER PULLEY 18T [DOUBLE BEARING]	1
28	002.004.0021	SPACER 17x1.5	1
29	003.007.0025	SHORT ACCESSORY SCREW	3
30	004.001.0013	CABLE PORT QUAD [2x5mm 2x3mm]	1

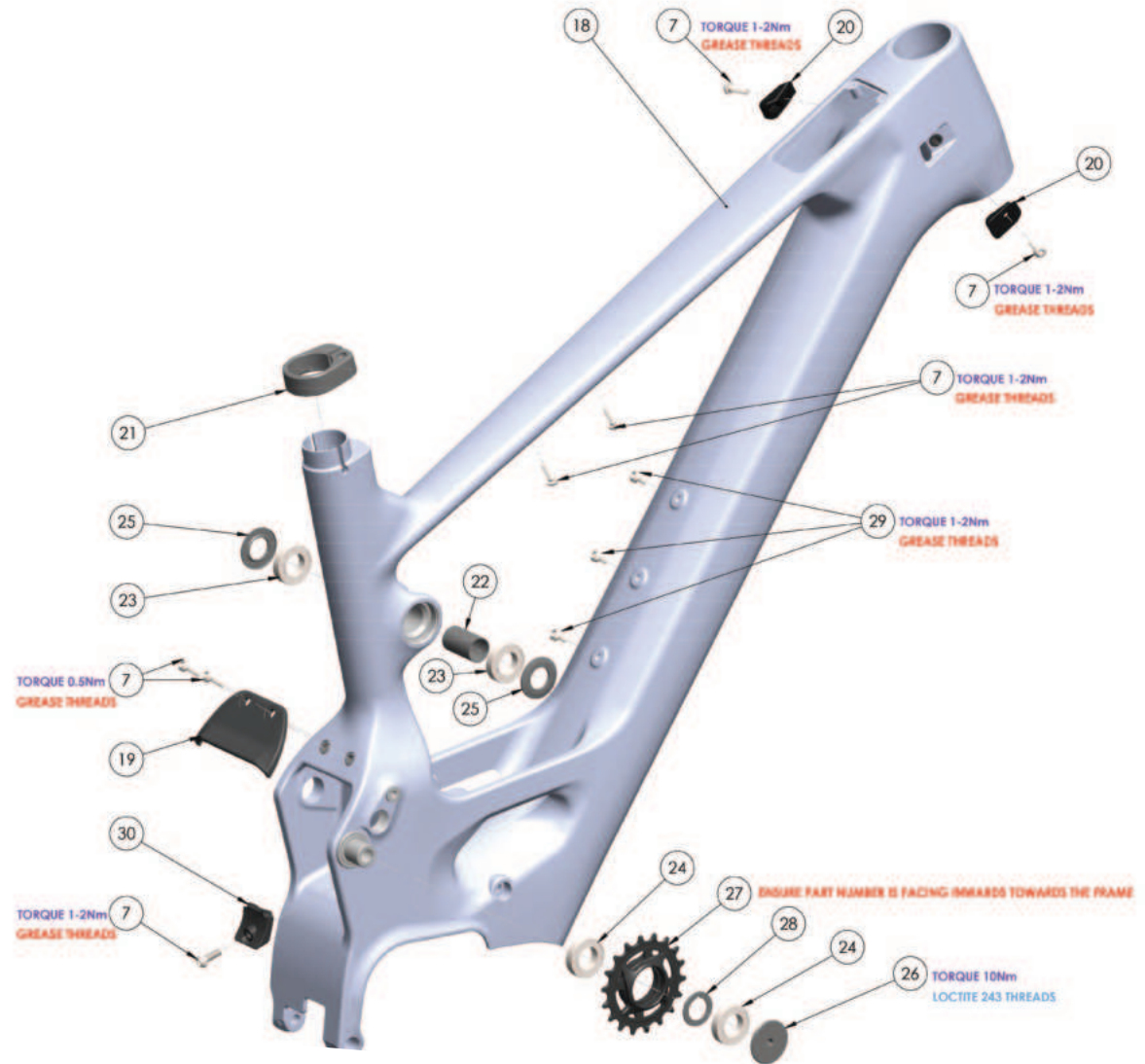

EXPLODED VIEWS

ROCKER LINK & MAIN PIVOT

ITEM NO.	PART NO.	DESCRIPTION	QTY
11	-	ENDURO 6901 LLU MAX	2
31	-	ROCKER LINK	1
32	002.004.0010	SPACER 10X4 FLANGED TOP HAT	2
33	002.002.0006	SCREW 10X1X18.5 24OD	2
34	002.001.0020	SHAFT 17X66 EXT	1
35	003.007.0022	M6 X 20 TAPER SOCKET SCREW 5MM HEX	2
36	002.005.0003	M6 X 1.6 WASHER 11MM OD	2
37	002.005.0001	TAPERED WASHER 17MM	2
38	002.001.0013	SHAFT 17X50 EXT	1

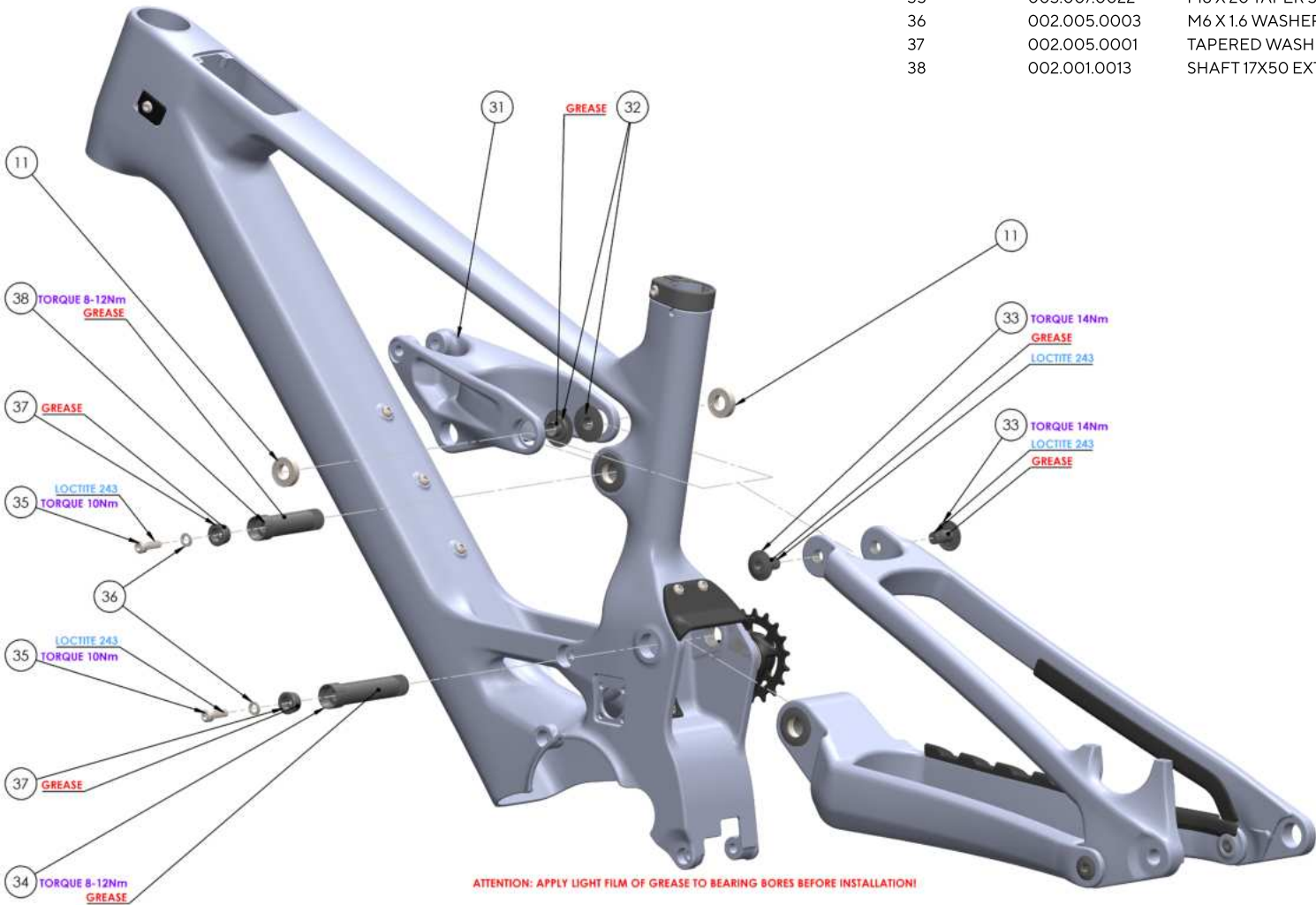

ATTENTION: APPLY LIGHT FILM OF GREASE TO BEARING BORES BEFORE INSTALLATION!

EXPLODED VIEWS

DOWNTUBE PROTECTION, CHAINGUIDE & SHOCK

ITEM NO.	PART NO.	DESCRIPTION	QTY
35	003.007.0022	M6 x 20 TAPER SOCKET SCREW 5mm HEX	3
39	004.002.0030	E-MTB LOWER DOWNTUBE GUARD	1
40	004.002.0032	SHUTTLE GUARD	1
41	004.002.0031	SHUTTLE GUARD & BUMP STOP	1
42	004.003.0010	V2 RACE GUIDE	1
43	003.007.0014	M5 x 16 - LEFT HAND THREAD SCREW 3mm HEX	1
44	003.007.0024	SHOCK SCREW 8x1.25x54	2

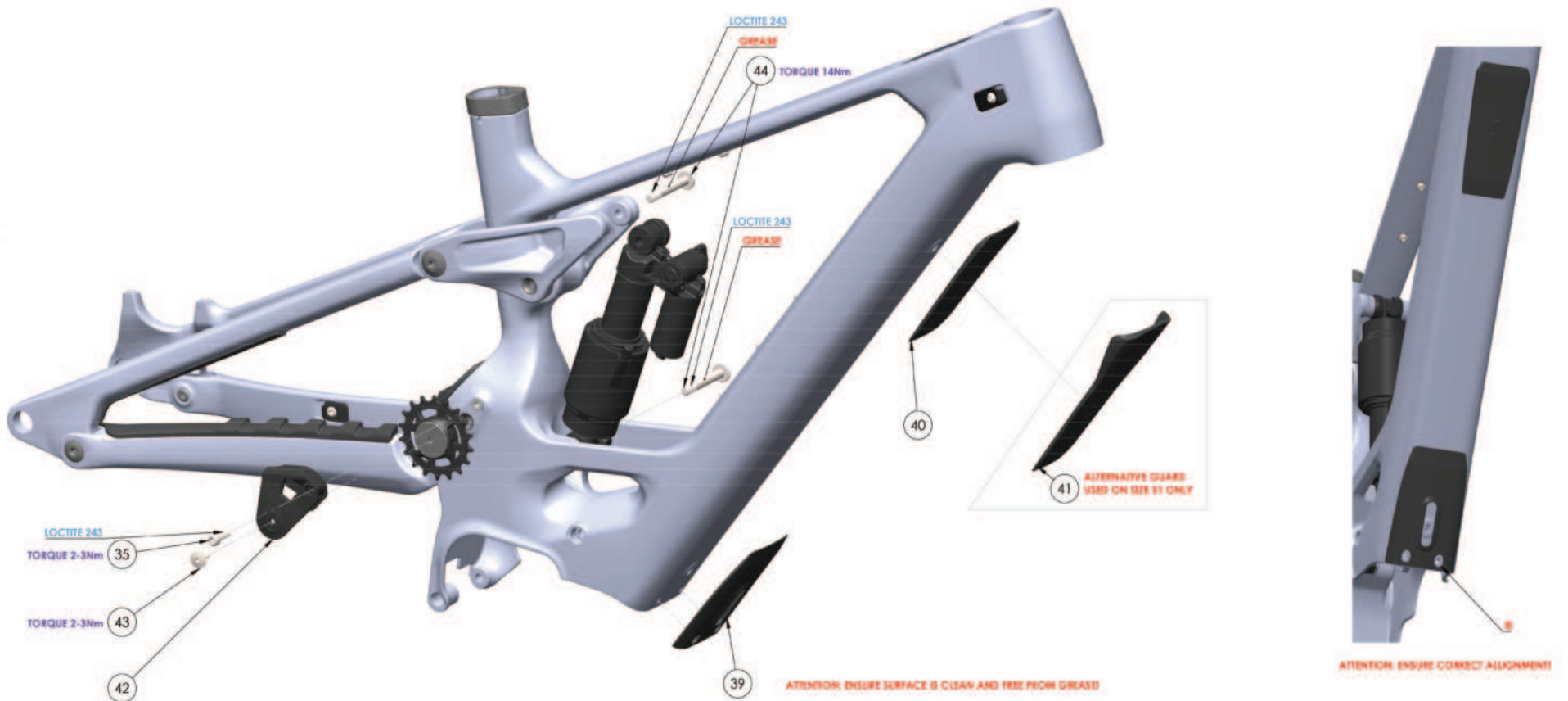
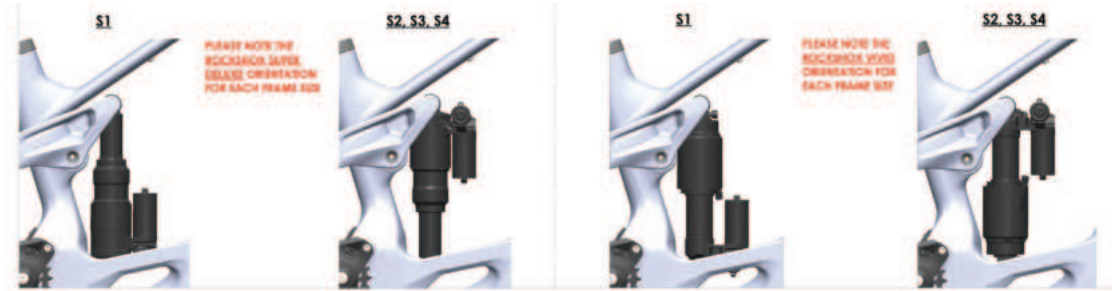

CABLE ROUTING OVERVIEW

ITEM NO.	PART NO.	DESCRIPTION	QTY
45	004.002.0025	SPEED SENSOR HOLDER	1
46	003.007.0012	M4 x10 SOCKET SCREW 4mm HEX	1
47	-	M3 AVINOX SPEED SENSOR SCREW 2mm HEX	1

ATTENTION: FOR FULL DETAILS ON HOW TO ROUTE EACH CABLE/HOSE PLEASE SEE THE NEXT PAGE

- KEY:**
- A - DISPLAY CABLE
 - B - DROPPER POST CABLE
 - C - REAR DERAILLEUR CABLE
 - D - BRAKE HOSE
 - E - SPEED SENSOR CABLE
 - F - POWER CABLE PORT
 - G - AXS EXTENSION CABLE PORT

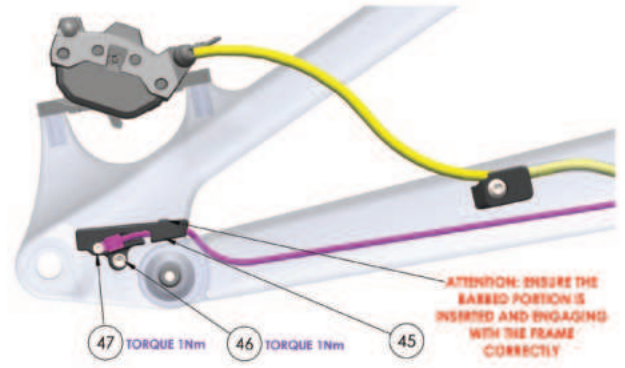
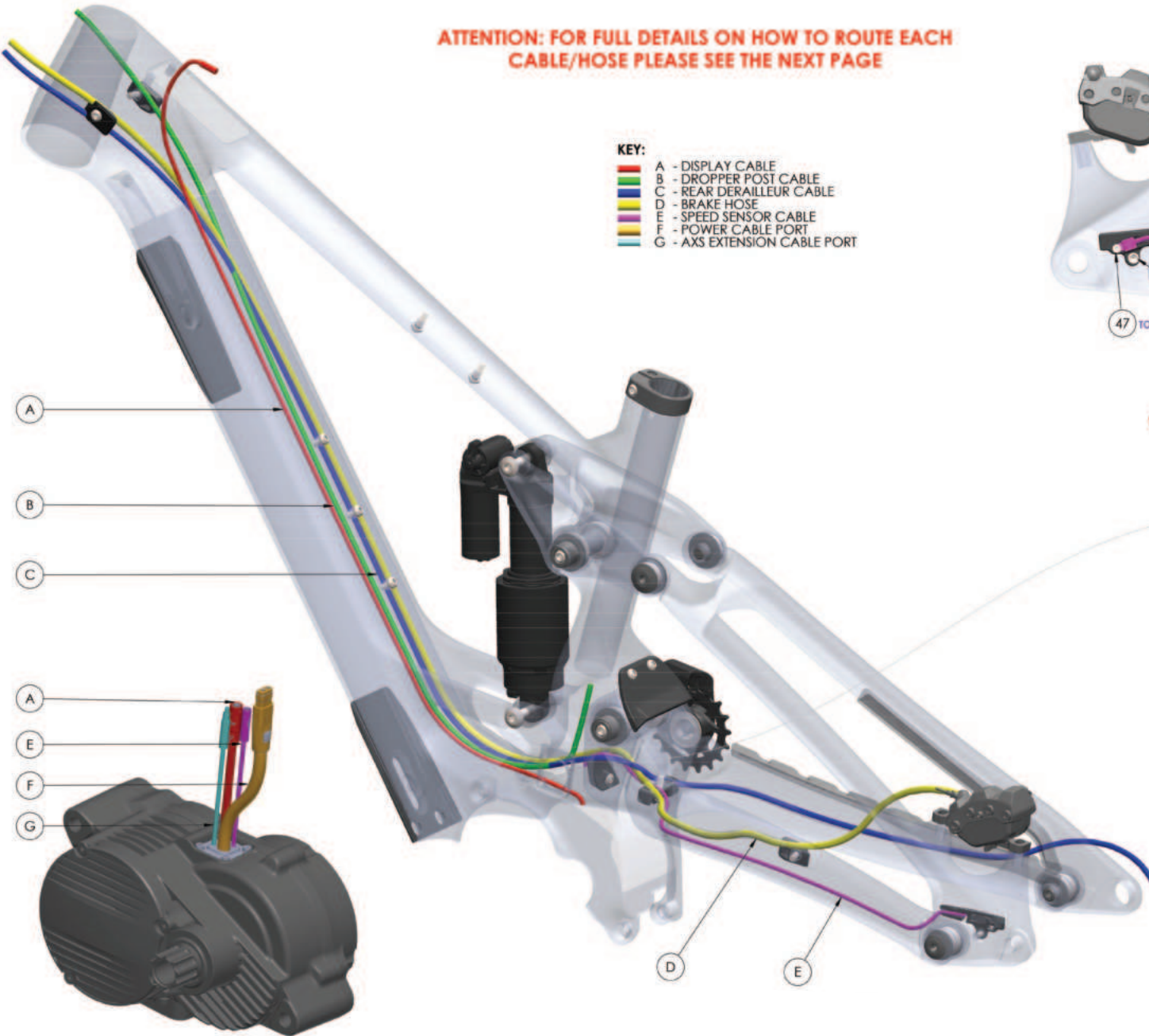



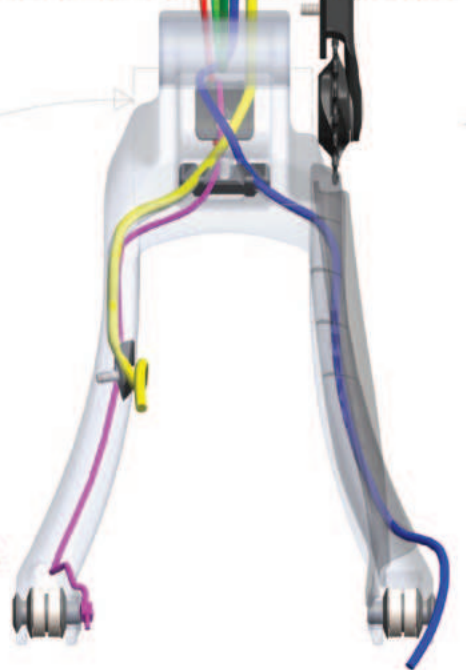

ATTENTION: SEE HOW THE REAR DERAILLEUR CABLE CROSSES OVER THE TOP OF THE BRAKE HOSE IN THIS ZONE. FULL DETAILS ON THE NEXT PAGE



CABLE ROUTING

DETAILED VIEW

KEY

-  A - DISPLAY CABLE
-  B - DROPPER POST CABLE
-  C - REAR DERAILLEUR CABLE
-  D - BRAKE HOSE
-  E - SPEED SENSOR CABLE

STEP 1: A - DISPLAY CABLE

STARTING FROM THE DISPLAY PORT IN THE TOP TUBE
ROUTE THE CABLE ALONG THE TOP OF THE DOWNTUBE

STEP 2: B - DROPPER POST CABLE

ROUTE THROUGH THE RIGHT-HAND HEAD TUBE CABLE PORT
ROUTE THE CABLE ALONG THE TOP OF THE DOWNTUBE
WITH THE MOTOR REMOVED, ROUTE CABLE UP THE SEAT TUBE



STEP 3: C, D & E - REAR DERAILLEUR CABLE, BRAKE HOSE & SPEED SENSOR CABLE

3.1:
REMOVE THE SHOCK AND CYCLE THE SUSPENSION TO FULL COMPRESSION (BOTTOMED OUT). USE A STRAP TO HOLD IT IN THIS POSITION. THIS WILL PROVIDE BETTER ACCESS TO THE UNDERSIDE OF THE MAIN PIVOT AREA.

IT ALSO HELPS TO ROTATE THE FRAME IN THE BIKE STAND SO THAT THE MAIN PIVOT AREA IS AT HEAD HEIGHT TO WORK ON.

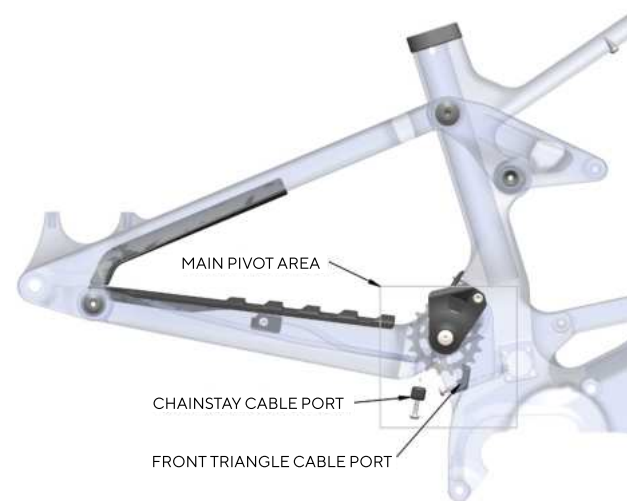

3.2:
REMOVE THE CABLE PORT CLAMPS FROM THE CHAINSTAY AND THE FRONT TRIANGLE IN THAT MAIN PIVOT AREA

3.3:

FASTEN THE BRAKE CALIPER, REAR DERAILLEUR AND SPEED SENSOR IN POSITION AND THEN START ROUTING FROM THE BACK OF THE BIKE AND WORK FORWARDS.

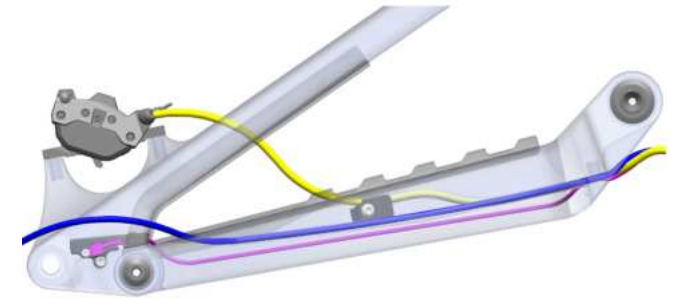

ROUTE FROM THE BACK, TOWARDS THE FRONT →

CABLE ROUTING

DETAILED VIEW CONTINUED

KEY

- A - DISPLAY CABLE
- B - DROPPER POST CABLE
- C - REAR DERAILLEUR CABLE
- D - BRAKE HOSE
- E - SPEED SENSOR CABLE

3.4: THE CHAINSTAY PROTECTOR WILL NEED TO BE PERFORATED USING A PICK. THE DERAILLEUR CABLE HOUSING OR AXS EXTENSION CORD CAN THEN BE PUSHED THROUGH THE OPENING.



PERFORATE

AXS EXTENSION CORD



DERAILLEUR HOUSING

3.5: THE CABLES AND BRAKE HOSE WILL EXIT THE CHAINSTAY PORTS NEAR THE MAIN PIVOT. FROM HERE THEY NEED TO PASS INTO THE FRONT TRIANGLE THROUGH THE PORT AT THE BOTTOM OF THE SEAT TUBE.

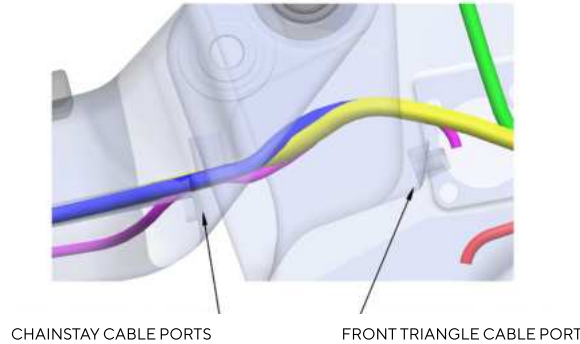

CHAINSTAY CABLE PORTS

FRONT TRIANGLE CABLE PORT

3.6: ARRANGE THE CABLES AND BRAKE HOSE AS SHOWN IN THE ILLUSTRATIONS BELOW, AND RE-INSTALL THE CABLE PORT CLAMPS:

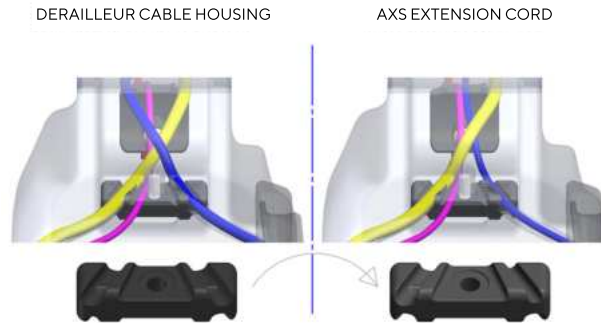

THE CHAINSTAY CABLE PORT CLAMP IS BI-DIRECTIONAL. FLIP IT ALONG ITS LENGTH TO SUIT THE CABLE HOUSING OR AXS EXTENSION CORD:

3.7:

WITH THE REAR SUSPENSION AT FULL COMPRESSION (BOTTOMED OUT), CLAMP THE CABLES AND HOSE IN PLACE [1-2Nm]. BE CAREFUL NOT TO PINCH ANY OF THE CABLES OR OVER-TIGHTEN AND PINCH THE INNER CABLE.

ONCE CLAMPED, THE SUSPENSION CAN BE CYCLED TO FULL EXTENSION AND RE-INSTALL THE SHOCK.

3.8:

THE SPEED SENSOR CABLE AND AXS EXTENSION CORD PLUG INTO THE MOTOR, SEE THE ILLUSTRATION ON THE PREVIOUS PAGE FOR WHICH CONNECTORS THEY PLUG INTO.

DERAILLEUR CABLE HOUSING AND BRAKE HOSE ARE ROUTED ALONG THE TOP OF THE DOWNTUBE AND UP TOWARDS THE HEAD TUBE. USE THE DISPLAY PORT IN THE TOP TUBE TO HELP GUIDE THE CABLE/HOSE THROUGH THE HEAD TUBE CABLE PORTS.

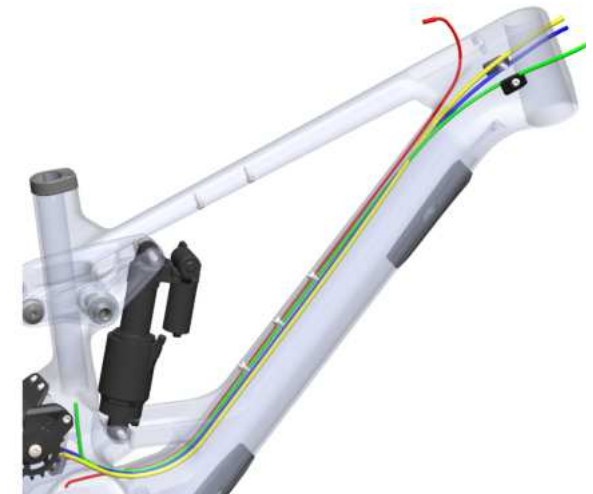

BATTERY & MOTOR INSTALLATION

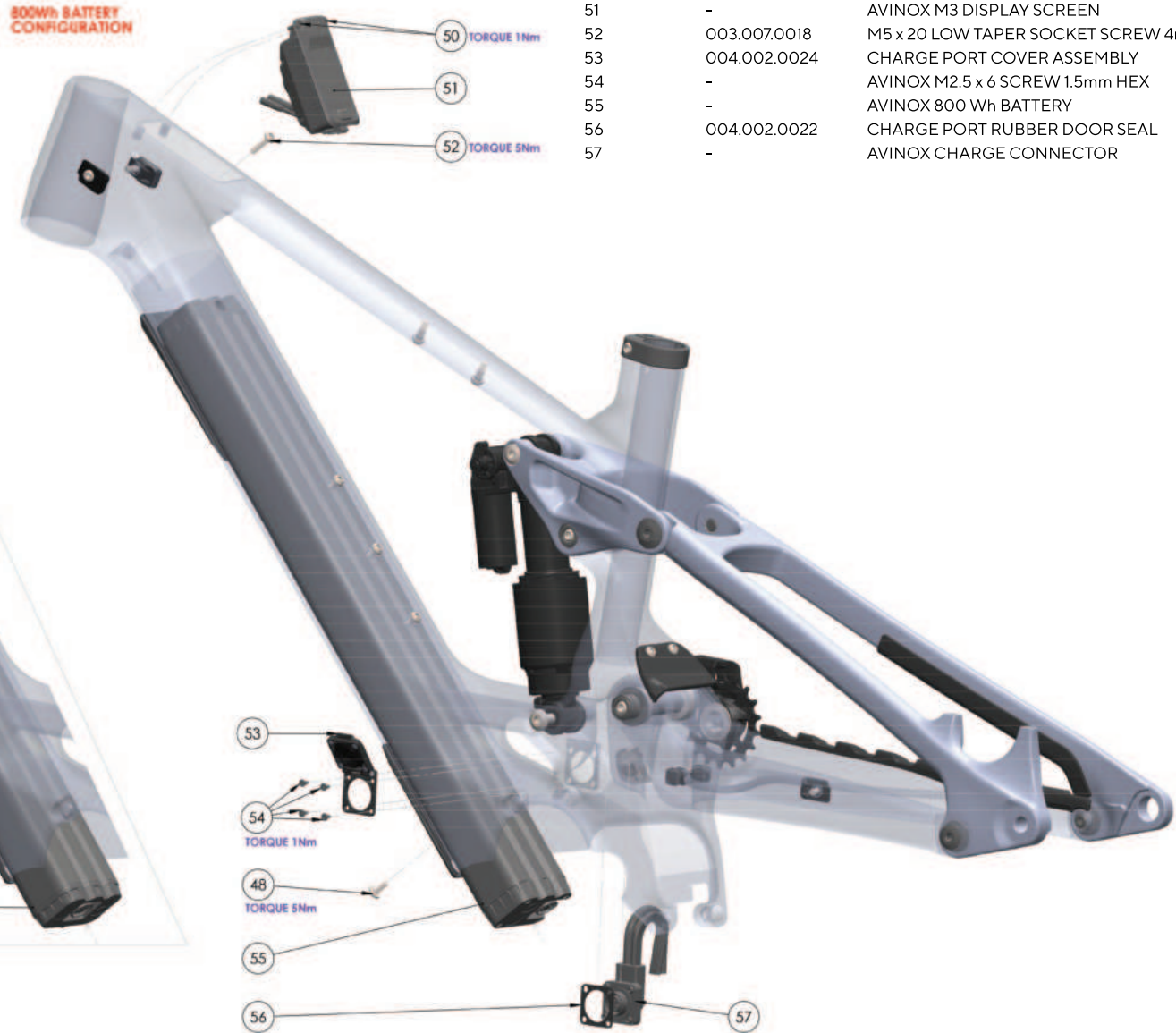

ITEM NO.	PART NO.	DESCRIPTION	QTY
48	003.007.0021	M5 x 13 WIDE HEAD SOCKET SCREW 4mm HEX	1or 2
49	-	AVINOX 600Wh BATTERY	1
50	-	AVINOX M3 DISPLAY SCREEN SCREW 2mm HEX	2
51	-	AVINOX M3 DISPLAY SCREEN	1
52	003.007.0018	M5 x 20 LOW TAPER SOCKET SCREW 4mm HEX	1
53	004.002.0024	CHARGE PORT COVER ASSEMBLY	1
54	-	AVINOX M2.5 x 6 SCREW 1.5mm HEX	4
55	-	AVINOX 800 Wh BATTERY	1
56	004.002.0022	CHARGE PORT RUBBER DOOR SEAL	1
57	-	AVINOX CHARGE CONNECTOR	1

BATTERY & MOTOR INSTALLATION

CONTINUED

ITEM NO.	PART NO.	DESCRIPTION	QTY
58	-	AVINOX M1 MOTOR	1
59	-	AVINOX MOUNTING BOLT [UP] 6mm HEX	1
60	-	AVINOX M8 x 1.25 NUT 8mm HEX	2
61	-	AVINOX MOUNTING BOLT [DOWN] 6mm HEX	1
62	-	AVINOX LOCKING WASHER	4
63	004.002.0028	MOTOR COVERS S1-S2	1
64	004.002.0029	MOTOR COVERS S3-S4	1
65	003.007.0023	M4 x 10 LOW TAPER SOCKET SCREW 3mm HEX	3

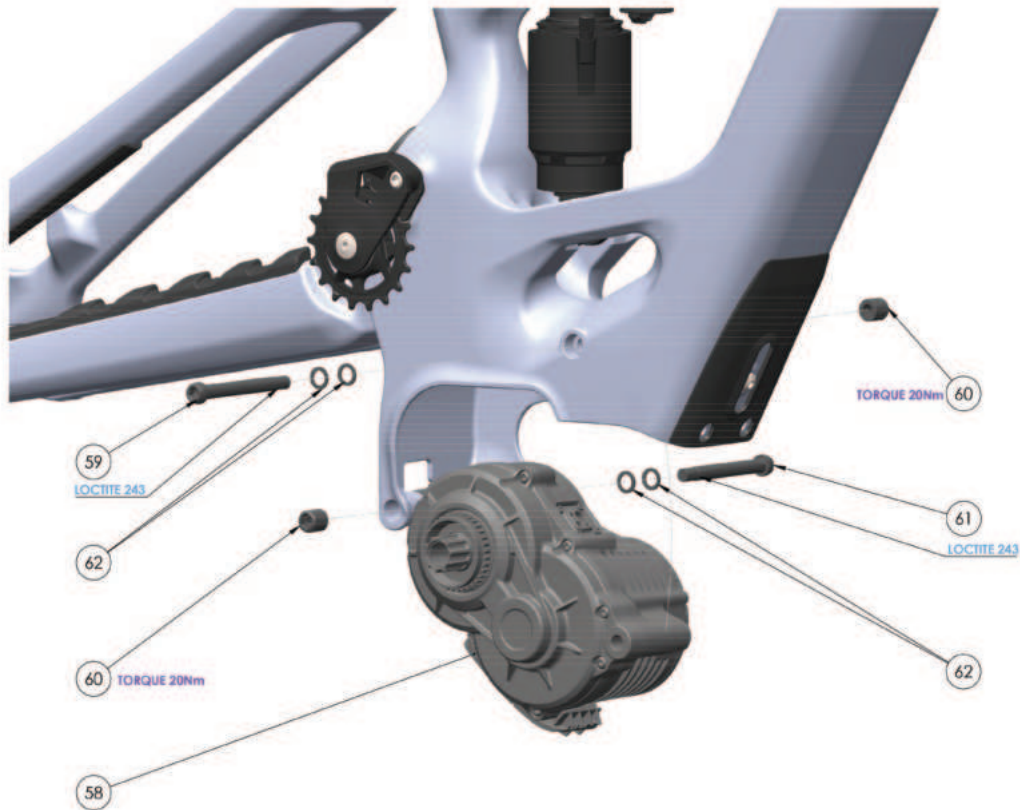

CRANK & SPIDER INSTALLATION

ITEM NO.	PART NO.	DESCRIPTION	QTY
66	-	CHAINRING	1
67	-	PRAXIS CRANKS	2
68	-	CHAINRING BOLTS	4
69	-	CHAINRING NUTS	4
70	-	PRAXIS SPIDER 104BCD	1
71	-	SPIDER LICKING RING	1

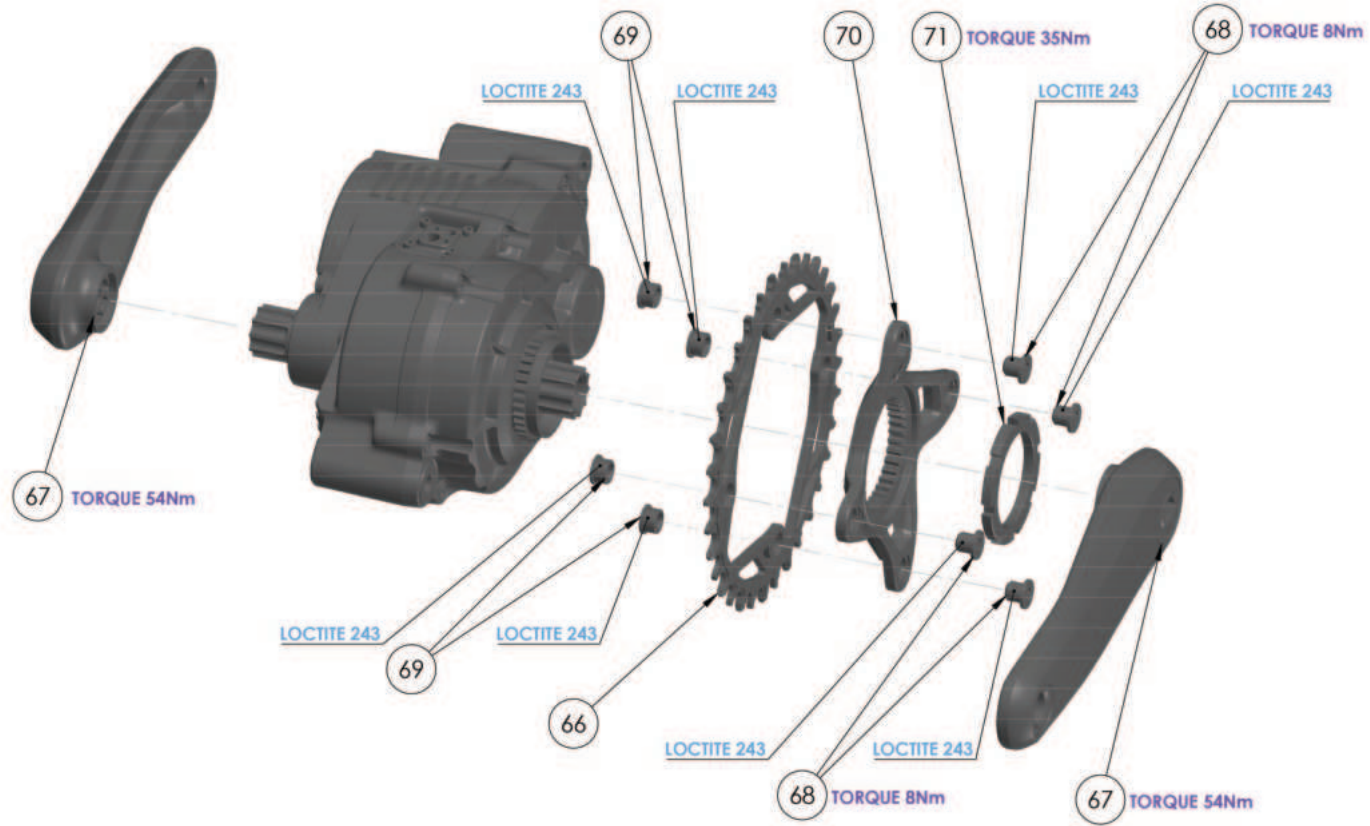

AVINOX SYSTEM

DRIVE SYSTEM

The bike is equipped with Avinox Drive System. Visit the following website for the user manual to learn more about the advanced functions and maintenance information about the drive system:



DOWNLOAD AVINOX APP

It is recommended to connect with the Avinox app for a better user experience. Scan the QR code to download the latest version.



PAIR & ACTIVATE

When powered on for the first time, follow the prompt on the bike screen to complete pairing and activation. Tap Skip and you can ride for trial without activation. After the trial distance has run out, follow the steps below to pair and activate before you can continue to use it.

1. Press and hold the power button of the control display to power on.
2. Swipe up on the screen to enter Settings and tap Pair to App to view the QR code.
3. Make sure Bluetooth and network are enabled on your mobile device. Open the Avinox App, then tap Pair and scan the QR code to pair.

AVINOX SYSTEM

BUTTON FEATURES

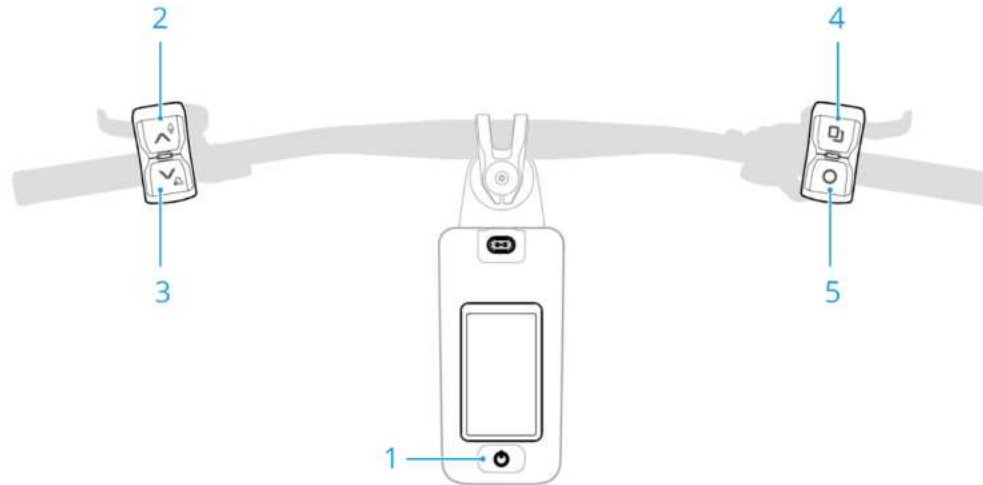

1. Power Button

Press and hold to power on/off. Press and hold for 20 s to force power off. When powered on for the first time, follow the prompts to select the language and activate the system.

After powering on, press to switch the assist modes between Off, Auto, Eco, Trail, and Turbo.

2. Assistance Level Increase Button

Press to switch the assist modes in the order of Off > Auto > Eco > Trail > Turbo.

Press and hold to activate Boost mode, and the bike screen will display a countdown. Press the power button or assistance level increase/decrease buttons to exit Boost mode.

3. Assistance Level Decrease Button

Press to switch the assist modes in the order of Turbo > Trail > Eco > Auto > Off.

Press and hold and then release the button to activate Walk mode.

Once activated, press and hold the button to get power assistance to help push the bike uphill. Press any other button to exit Walk mode.

4. Screen Switch Button (customizable)

Press to control the bike screen to slide right.

Swipe up on the bike screen to enter Settings, and then you can customize functions for the button in Customize Controls.

5. Function Button (customizable)

Press to control the bike screen to slide left. When the bike screen is on the Settings page, press to return to the previous page.

Swipe up on the bike screen to enter Settings, and then you can customize functions for the button in Customize Controls.

AVINOX SYSTEM

ASSIST & ADDITIONAL MODES

ASSIST MODES

The four stock modes offer varying levels of assistance to handle different riding scenarios.

Auto Mode: This mode automatically adjusts assistance based on different riding situations, providing moderate assistance to enhance the range.

Eco Mode: With gradual start-up acceleration and lower assistance, this mode conserves battery energy and is suitable for longer-distance mellow riding.

Trail Mode: This mode provides moderate start-up acceleration and stronger assistance and is suitable for those grunter climbs and technical routes.

Turbo Mode: This mode provides maximum acceleration and maximum assistance. Good for getting places, fast!

ADDITIONAL MODES

Boost Mode

In addition to the standard assist modes, the drive system also supports the Boost mode with extra assistance for a short duration, which can help users ride with greater drive torque and power. This mode is suitable for challenging riding scenarios such as overcoming obstacles and climbing hills.

Press and hold \wedge to activate Boost mode. During the period, the assistance will shut off when you stop pedalling. To exit Boost mode, press the power button or the assistance level increase/decrease buttons.

Walk Mode

Press and hold \vee to activate Walk mode, then press and hold the button to get power assistance when pushing the bike or starting upon an incline. It also supports auto hold to prevent rollback on slopes. The assistance will shut off automatically when stop pressing \vee or the speed exceeds 6 km/h.

Stationary Gear Shifting

Stationary gear shifting is supported when using Walk mode. After activating Walk mode, press the shift lever and lift the rear wheel, then press \vee twice to shift gears quickly

 **WARNING** - ONLY USE WALK MODE WHEN PUSHING THE BIKE. USING IT IN INAPPROPRIATE SITUATIONS MAY CAUSE ACCIDENTS AND PERSONAL INJURY.

 **WARNING** - ENSURE TO KEEP YOUR BODY AWAY FROM THE ROTATING CRANK AND PEDALS TO AVOID INJURY WHEN USING WALK MODE TO ASSIST PUSHING THE BIKE AND GEAR SHIFTING.

BATTERY & CHARGING

 **WARNING** - MAKE SURE TO USE THE OFFICIAL AVINOX CHARGER AND PLUG THE CHARGER DIRECTLY INTO A STANDARD WALL OUTLET; DO NOT USE EXTENSION LEADS.

 **WARNING**- ALWAYS BE PRESENT WHEN CHARGING YOUR BATTERY, AND DISCONNECT IT WHEN IT IS FULLY CHARGED. DO NOT LEAVE YOUR BATTERY PLUGGED IN OR LET IT CHARGE OVERNIGHT.

 **WARNING** - MAKE SURE TO USE THE OFFICIAL AVINOX CHARGER AND PLUG THE CHARGER DIRECTLY INTO A STANDARD WALL OUTLET; DO NOT USE EXTENSION LEADS.

 **WARNING**- ALWAYS BE PRESENT WHEN CHARGING YOUR BATTERY, AND DISCONNECT IT WHEN IT IS FULLY CHARGED. DO NOT LEAVE YOUR BATTERY PLUGGED IN OR LET IT CHARGE OVERNIGHT.

BATTERY DISPOSAL



Batteries, chargers and electronic devices cannot be disposed of through general refuse collection. They must be disposed of in an environmentally friendly manner following the applicable regulations in your country or state.



EUROPE: According to European Guideline 2012/19/EC and European Guideline 2006/66/EC, electronic devices/tools and batteries must be recycled separately and disposed of in an environmentally friendly manner.

BATTERY & CHARGING

CHARGING INSTRUCTIONS

1. Open the charging port cover and connect the charger
2. During charging, the bike screen will display the current battery level and estimated time to full charge
3. Unplug the charger and close the port cover after the battery is fully charged.
DO NOT pull the power cable by force when removing the charger

LED INDICATOR :



RED: The battery is charging

GREEN: Fully charged

YELLOW: The charger is connected incorrectly or abnormally

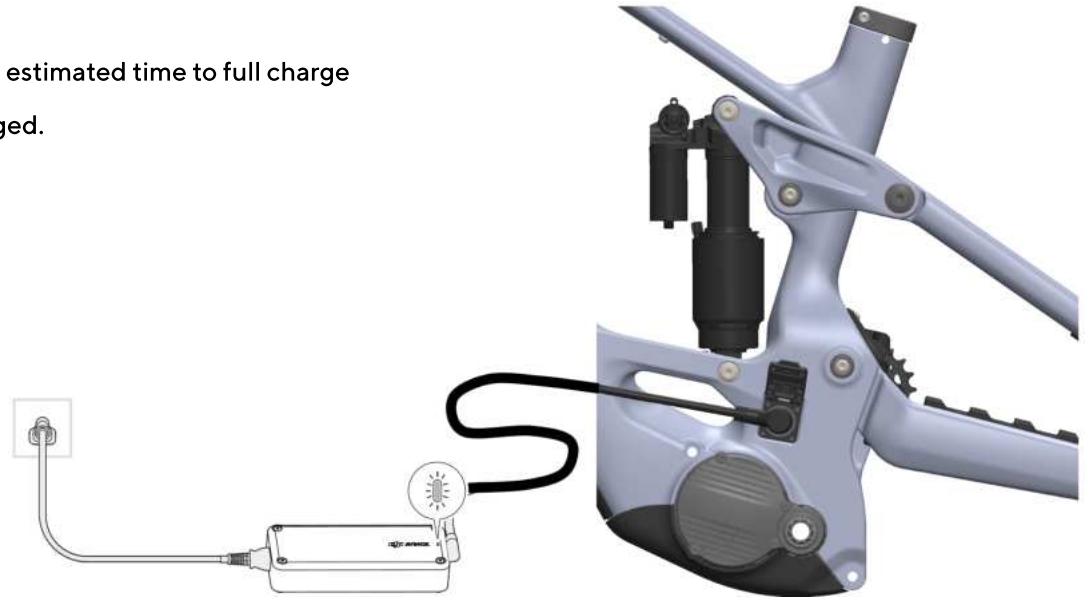

CHARGE TIMES

800Wh

600Wh

168W 4A Charger

approx. 5 h 50 min (0-100%)

approx. 4 h 28 min (0-75%)

168W 4A Charger

approx. 4 h 45 min (0-100%)

approx. 3 h 3 min (0-75%)

508W 12A Charger

approx. 2 h 25 min (0-100%)

approx. 1 h 30 min (0-75%)

508W 12A Charger

approx. 2 h 25 min (0-100%)

approx. 1 h 30 min (0-75%)

CHARGING EXTERNAL DEVICES

Use a USB-C cable to connect the control display to an external device.
Then, power on the control display to charge the connected device.

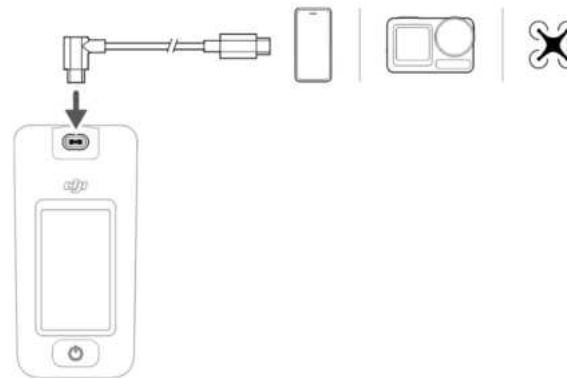

BATTERY CARE, SAFETY & TRANSPORTATION GUIDELINES

GUIDELINE	DETAILS
Storage Temperature	Store in a cool, dry place between 0°C to 40°C (32°F to 104°F). Avoid direct sunlight.
Battery Monitoring	Check battery levels and cycle counts regularly. Capacity may decline after 500 cycles (won't impact riding).
Low Battery Charging	Charge promptly when below 10% to avoid affecting battery life.
Extended Inactivity	Fully discharge and recharge once every 3 months if unused for a while.
Damaged Charger Port or Cable	Stop using immediately if signs of wear/damage are present. Disconnect when fully charged. Overcharging can damage battery cells.
Overcharging	Avoid charging at high temperatures. Let the battery cool to room temperature before charging.
High Temperature Charging	0°C to 40°C (32°F to 104°F) for optimal battery life.
Ideal Charging Temperature	Remove from frame and keep out of children's reach. Discharge to 30% before long-term storage.
Storing Long-Term	Storing with high charge shortens life; low charge risks over-discharge.
High/Low Charge Storage Risk	Discharge to ~30%, remove from frame, use a carrying box. Battery may fall out or connectors
Transportation	may wear out if left in bike during transport.
Damaged Battery	Do NOT transport a damaged battery.

MAINTENANCE

Here at Forbidden, we take pride in the level of craftsmanship we apply to each and every bike we sell. Tested beyond the safety standards adopted by many in the industry, we stand by our product 100%. But mountain biking by its very nature puts a lot of stress on equipment, all of which will wear differently and fatigue at differing rates, and may even fail without warning. We therefore recommend that you regularly inspect your bike for any signs of damage and wear and replace any worn and damaged components. If you don't have the necessary skills, please refer to your local bike shop or Forbidden dealer. Loose bolts can lead to frame damage (and potential failure) that is not covered under warranty. Please use the torque wrench and refer to the torque settings outlined in the exploded views. If you are not confident in conducting these checks, please contact your local bike shop.

REPLACING PARTS

When replacing any worn or damaged components, we recommend that you replace them with original equipment (OE) parts or similar. Please refer to our website to determine the OE part specification of your bike build.

WARNING

Replaced suspension components **MUST** meet the same specification as the OE parts. This includes shock length and stroke, as well as fork offset and steerer tube diameter.

MAINTENANCE

TAKING CARE OF CARBON

- Never clamp your carbon frame directly in a bike stand, as it can severely damage your frame. Instead, clamp the seat post.
- Be careful with bike racks and transporting in cars. Do not overload the frame with bike rack clamps, and be careful not to overload the frame when transporting inside cars.
- Never tighten your rear axle without the wheel installed in the frame, as the lateral forces can damage the stays.
- Never tighten your seat clamp without a seat post installed, as it can damage your frame.
- Do not leave aluminum components in direct contact with carbon without first applying a film of high-quality grease or carbon paste - components can corrode and bind to your frame over time.
- Never tighten fittings over the specified torque values, ever.
- Never subject carbon to high temperatures. This can severely degrade the structural integrity of carbon.
- Clean with warm water and, where possible, proper bicycle detergent and avoid all solvent-based cleaners.
- Cover high wear areas with protective adhesive films (eg: areas exposed to rub from cables, heels, knees, etc.).

WARNING

Any damage that results from incorrect handling of your carbon frame will not be covered under warranty

CRASHES

Crashes do happen, and sometimes things break and become damaged as a result. If you've had a crash, please make sure to thoroughly check your bike for any signs of damage before you continue on your ride - do not continue on your ride if you see any signs of damage! If you are unsure that your bike is safe to use, we strongly recommend that it is taken to a reputable local bike shop and have them inspect it for any damage. Due to the nature of carbon fibre, crashes can cause damage without showing any visible signs. If you are unsure, seek professional advice and, where possible, replace the component in question. Forbidden has a crash replacement program that will help get you and your bike on the trails.

AFTER AN IMPACT

1. Check the whole bike if there are any deformations, damage, or cracks. If any issues are detected, do not continue riding the bike. Take it to an authorized retailer for a thorough inspection.
2. If you hear any unusual noise, check if the bolts, bearings, and any other connecting parts are loose.
3. Check the battery: If the battery charging port is damaged or the battery is no longer securely fixed in the down tube, do not continue to use it.
4. Check if there are any error messages displayed on the control display. Follow the instructions to troubleshoot before continuing to use.

MAINTENANCE

MAINTENANCE SCHEDULE

FRAME SIZE	BEFORE EVERY RIDE	AS NECESSARY	WEEKLY/MONTHLY	6-12 MONTHS
Check wheels are securely mounted and axles torqued	✓			
Wheels spin freely - no brake rub, resistance, or wobble	✓			
Check brake function and pad wear	✓			
Headset moves freely with no play	✓			
Handlebar grips, stem, and seatpost secure with no damage*	✓			
Check tire tread and sidewalls for damage; confirm pressure is within recommended range	✓			
Clean and lubricate chain and drivetrain	✓			
Replace worn brake pads		✓		
Clean derailleur and speed sensor		✓		
Replace tires with excessive wear		✓		
Inspect rims for damage (buckles, cracks)**			✓	
Inspect all components for damage or wear			✓	
Ensure all cockpit parts are torqued to spec			✓	
Torque all bolts and fittings			✓	
True wheels and check spoke tension			✓	
Confirm brake pads are adequate; no fluid leaks			✓	
Inspect and adjust gear shifting			✓	
Check for system updates and new firmware			✓	
Front and rear suspension adjusted and not leaking			✓	✓ FULL SERVICE
Clean and re-grease headset and freehubs				✓
Rebuild frame linkage; inspect/replace bearings				✓
Re-grease axles; torque fittings				✓
Dropper post service				✓
Full tune-up by competent mechanic				✓

WARNING

* If your grips are damaged and expose the end of the handlebar, this could lead to severe injury or death. Replace them immediately.

** Composite rims can be difficult to assess for damage since the wear can be invisible to the user. If you are unsure about the integrity of your rims, please contact the manufacturer for professional advice.

WARRANTY

Warranty Info: forbiddenbike.com/customer-care/warranty/

Forbidden Bike Co. warrants each new Forbidden bicycle frame against defects in workmanship and materials it determines to be defective in materials or workmanship. The warranty will be in effect for the lifetime of the frame and is available only to the original owner. Forbidden Lifetime Frame Warranty applies to UDH-compatible Forbidden bicycle frames assembled in Cumberland BC from October 1, 2022, onward. All other frames are covered under the previously-existing warranty for five years from the original date of purchase.

THIS WARRANTY DOES NOT COVER:

- Normal wear and tear (including bearings).
- Improper assembly.
- Improper follow-up maintenance.
- Installation of parts or accessories not originally intended for, or compatible with, the frames as sold.
- Damage or failure due to accident, misuse, abuse, or neglect.
- Labour charges, shipping or other transportation charges for part replacement or changeover.
- Paint and graphics after the 120 day period immediately following the original purchase date.
- Paint damage caused by the installation or removal of protective tapes, films, stickers, or adhesives of any kind.
- Non Forbidden parts, please consult through your local bicycle dealer for any third party item warranties.

This warranty is expressly limited to the repair or replacement of a defective item and is the sole remedy of the warranty. Your replacement item will be the same or similar frame model, and at the sole discretion of Forbidden Bike Company. We cannot guarantee you will receive the same color item as the original item it is replacing.

If we cannot determine if the product is defective without the product being returned to us, you are responsible for the cost of shipping and handling to return the damaged product to us. If when the damaged product is returned to us, we then determine that the product is defective, we will pay for the shipping to return the repaired or replaced product to you. If we can determine that the product is defective prior to the product being returned to us, we will pay for shipping and handling fees to return the damaged product to us and to return the repaired or replacement product to you.

This limited warranty also does not cover third party components on any Forbidden Bike Company bicycle. Third party components may be covered by their respective manufacturer's warranty. For warranty service for third party components, please contact the respective manufacturer. Should the manufacturer require that you process such warranty claim through the business from whom you purchased the third party component, please contact either our authorized dealer or our customer service team, and our authorized dealer or we will be able to provide assistance and facilitation of such warranty claim. This warranty does not apply to damage caused by:

- collision
- crashing
- trick riding
- riding with heavy loads
- commercial activities
- any similar activities or misuse;

Such uses may damage the bicycle, can cause serious injury to the rider, and in all cases will void this warranty.

This warranty is void in its entirety by any modification of the frame, or it's components.

This warranty applies only to the original owner and is not transferable.

Claims under this warranty must be made through the point of sale. Proof of purchase is required.

This limited warranty is the only warranty applicable to **Forbidden Industries Ltd.**

PRODUCT LIABILITY WARNING

Please read carefully the product service instructions before use. Improper use and/or assembly, care and maintenance of this product can result in failure and/or personal injury. We are not liable for any personal injury or property damage that results from crashes, poor maintenance, incorrect assembly or failure of any component. We advise that you seek professional assistance when assembling this product prior to use. Mountain Biking involves risk and can be extremely dangerous. By choosing to participate in Mountain Biking, you assume responsibility for this risk. Please ensure you follow proper use and maintenance instructions and wear appropriate safety equipment.

For more details, visit www.forbiddenbikes.com or scan the QR code in your packaging.

TECHNICAL HELP

If you're experiencing technical issues with a DJI component on your Forbidden E-bike, take your bike to the nearest Forbidden dealer for assistance. You can also contact DJI customer service directly by scanning the QR Code below.



Find a Dealer



DJI Support

If you have a technical question about your Forbidden E-bike, scan the QR Code below to contact Forbidden Customer Service.



Forbidden
Customer Service

DECLARATION OF CONFORMITY

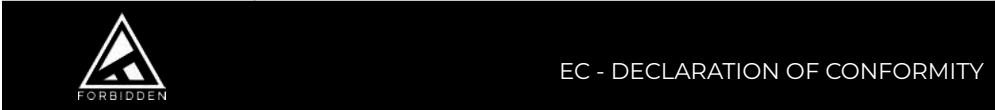

This declaration of conformity is issued under the sole responsibility of the manufacturer:

MANUFACTURER: Forbidden Industries Ltd. 2799
Beck Ave. Cumberland, BC
Canada, V0R 1S0.
Tel: +1 250 400-2900



MODEL YEAR: 2025

PRODUCT: Electrically Power Assisted Cycles – EPAC Bicycles Li-ion Battery Charger Rechargeable Li-ion Battery

MODEL NAME: Druid CorE 1 / Druid CorE 2 / CDX100-528 / BBX100-22300-35.9 /
Druid CorE 3 / Druid LiE 1 / CDX100-528 BBX100-16700-35.9
Druid LiE 2 / Druid LiE 3

DECLARATION: The manufacturer declares that all models above comply with all relevant requirements of the Machinery Directive (2006/42/EC) and Electromagnetic Compatibility Directive (2014/30/EU)

DOCUMENTS: The following standards have been applied: EN 15194:17

SIGNATURE:  Owen Pemberton Forbidden Industries Ltd. 2799 Beck Ave. Cumberland, BC Canada, V0R 1S0
July 12th, 2025

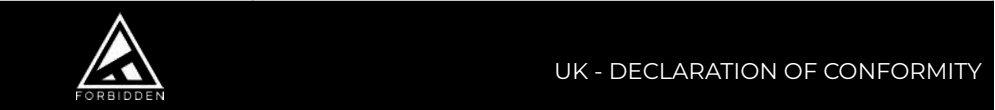

This declaration of conformity is issued under the sole responsibility of the manufacturer:

MANUFACTURER: Forbidden Industries UK Ltd.
Unit 14, Hanley Workshops,
Hanley Swan,
Worcestershire, WR8 0DX,
United Kingdom.



MODEL YEAR: 2025

PRODUCT: Electrically Power Assisted Cycles – EPAC Bicycles Li-ion Battery Charger Rechargeable Li-ion Battery

MODEL NAME: Druid CorE 1 / Druid CorE 2 / CDX100-528 / BBX100-22300-35.9 /
Druid CorE 3 / Druid LiE 1 / CDX100-528 BBX100-16700-35.9
Druid LiE 2 / Druid LiE 3

DECLARATION: The manufacturer declares that all models above comply with all relevant requirements of the Machinery Directive (2006/42/EC) and Electromagnetic Compatibility Directive (2014/30/EU)

DOCUMENTS: The following standards have been applied: BS EN 15194:17

SIGNATURE:  Owen Pemberton Forbidden Industries Ltd. 2799 Beck Ave. Cumberland, BC Canada, V0R 1S0
July 12th, 2025

